

# SLIDING DOOR SYSTEM\_ AIR

## TECHNICAL BOOK

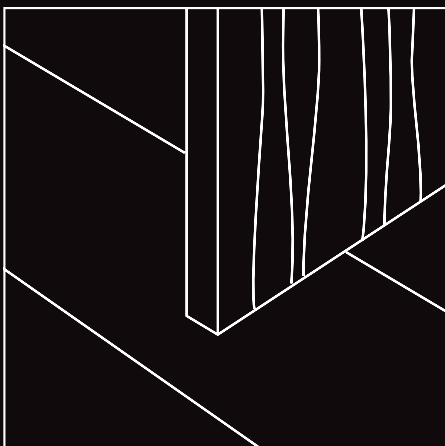
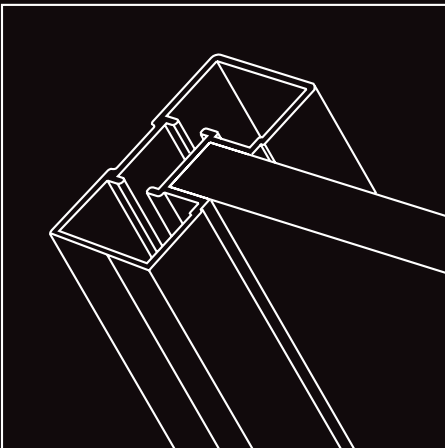
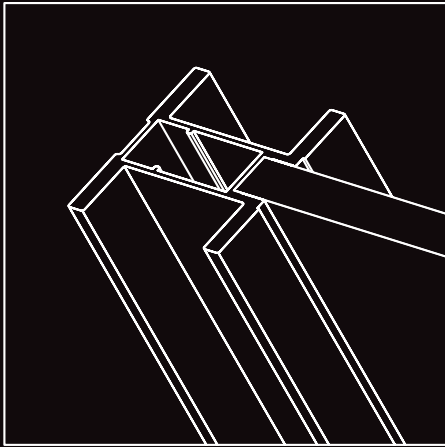

System description

Accessories

**raumplus**

SLIDING DOOR SYSTEM\_ AIR

1.0\_ System description\_ page 03

2.0\_ Profiles\_ page 04

3.0\_ Profile finishes\_ page 10

4.0\_ Panels\_ page 11

5.0\_ Top tracks\_ page 13

6.0\_ Accessories\_ page 15

7.0\_ Diagrams\_ Alignment\_ page 32

8.0\_ Diagrams\_ Ganging\_ page 36

# SYSTEM DESCRIPTION\_ AIR

## SLIDING DOOR SYSTEM

### 1.1\_ Overview

The key features of our made-to-measure system are versatility in customization and quality of our hardware allowing for individual solutions and unparalleled operation. The AIR system is an ideal solution for environments where an uninterrupted floor plane is required. See profiles for specifics.

Doors can be ordered fully assembled with our standard panel materials or as frame kits to accommodate a panel material of your choosing. Assembly of doors with customer's own materials (COM) is available; please contact Raumplus for more information.

### 1.2\_ Fully assembled door

Made-to-measure per specifications with the following design parameters:

- \_ Maximum height 2743mm [9' - 0"]
- \_ Maximum width 1219mm [4' - 0"]
- \_ Maximum weight 60kg [130lbs]
- \_ Standard finish: Clear anodized aluminum (silver)
- \_ Top track, Valance, L-bracket shipped 50mm [2"] over-length for trimming on-site

System components (quantity per door):

- Top Track
- 1\_ Valance (varies by order)
- 2\_ Top track (varies by order)
- Not shown:
- AIR Stopper with brake (2)
- Door
- 3\_ AIR Roller (2)
- 4\_ Fixation for top track (2)
- 5\_ Top rail (1)
- 6\_ Stile (2)
- 7\_ Frame screw (4)
- 8\_ Plug / cover (4)
- 9\_ Brush gasket (one stile only)
- 10\_ Panel (varies by order)
- 11\_ Panel gasket (all sides of panel)
- 12\_ Bottom rail (1)
- 13\_ Ground plate with roller (1)
- 14\_ Ground plate without roller (1)

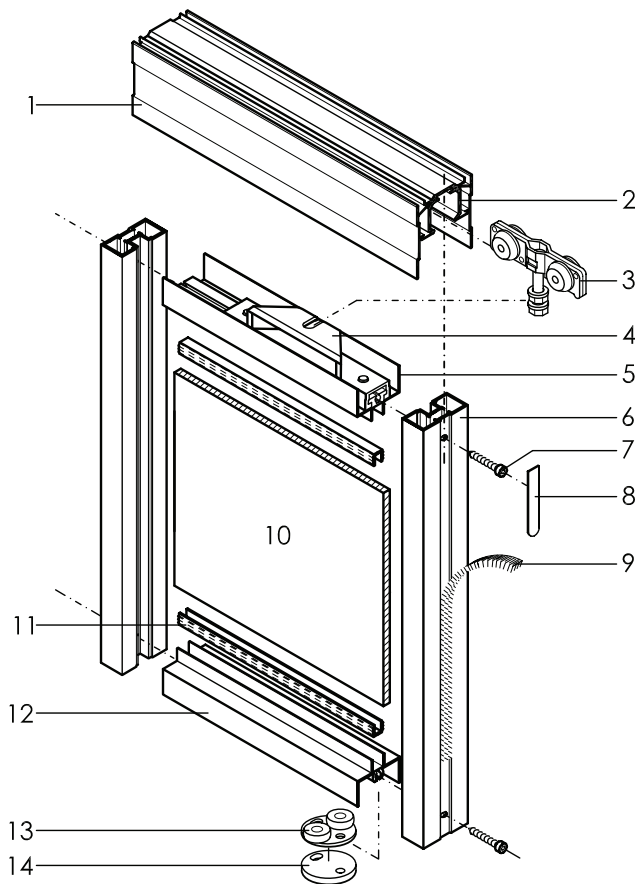

### 1.3\_ Frame kit

Frame kits are made-to-measure per specifications and ready for assembly using customer's own panel material. In addition to the design parameters listed for fully assembled doors, please consider the following:

- \_ Minimum panel thickness 4mm [5/32"]
- \_ Maximum glass thickness 8mm [5/16"]
- \_ Maximum solid panel thickness 10mm [3/8"]

Appropriate panel gasket to be specified when ordering:

- \_ 4mm [5/32"]
- \_ 5mm [3/16"]
- \_ 6mm [1/4"]
- \_ 7mm [9/32"]
- \_ 8mm [5/16"]

\*Gasket not required for solid 10mm [3/8"] material

# SYSTEM DESCRIPTION\_ AIR

## SLIDING DOOR SYSTEM

### 2\_ Profiles

#### 2.1\_ S1500 Isometric view / wall-mounted

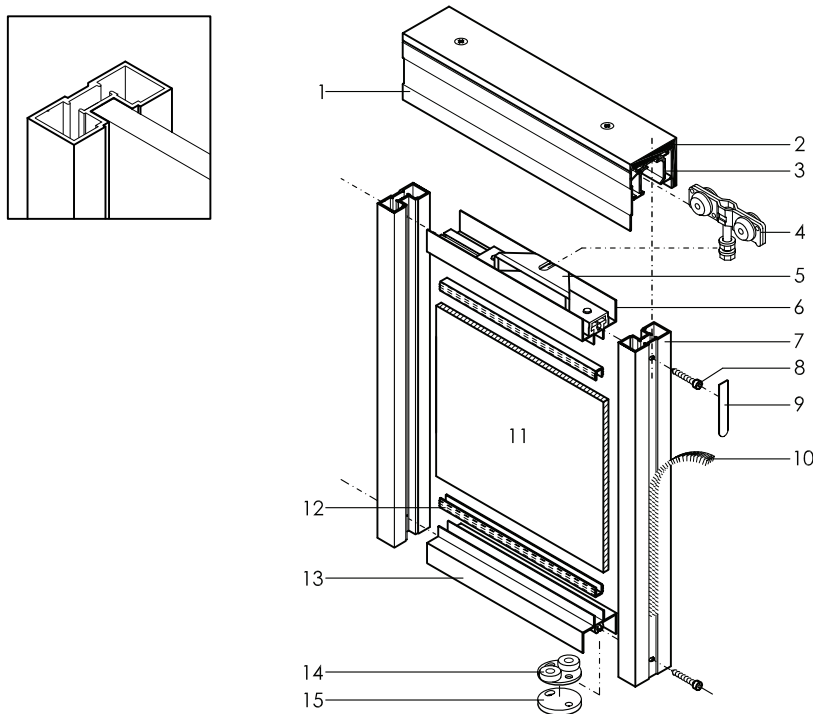

Each sliding door is composed of the following:

Top track

- 1\_ Valance (varies by order)
- 2\_ Continuous L-bracket (varies by order)
- 3\_ Top track (varies by order)

Not shown:

- AIR Stopper with brake (2)
- Door
- 4\_ AIR roller (2)
- 5\_ Fixation for top track (2)
- 6\_ Top rail (1)
- 7\_ Stile (2)
- 8\_ Frame screw (4)
- 9\_ Plug / cover (4)
- 10\_ Brush gasket (one stile only)
- 11\_ Panel (1)
- 12\_ Panel gasket (all sides of panel)
- 13\_ Bottom rail (1)
- 14\_ Ground plate with roller (1)
- 15\_ Ground plate without roller (1)

#### S1500 Section and stile detail / wall-mounted

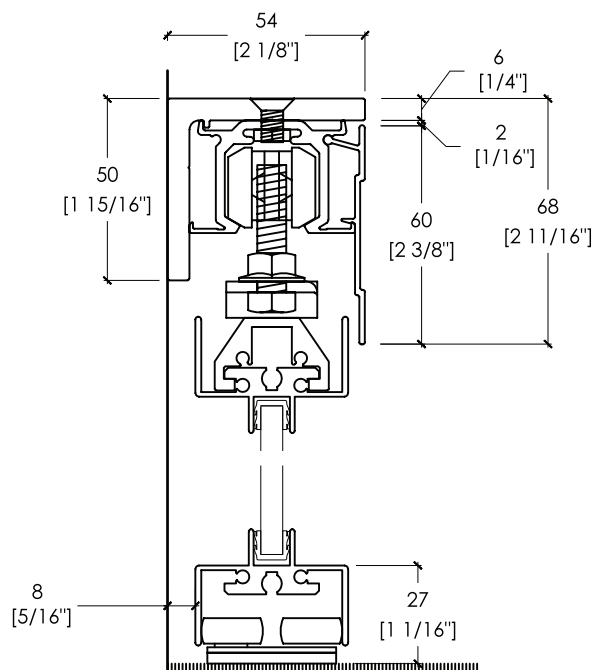

Square

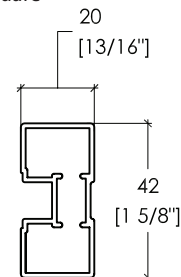

S1500 Stile

Finish

Standard: Clear anodized aluminum (silver)

Application

Residential / commercial projects

Dimensions

Max size 1219mm x 2743mm [4' x 9']

Max weight 60kg [130lbs]

Panel thickness 4mm [3/16\"/>

\*Door can not travel past ground plate with roller

Wall-mounted, single and bi-parting doors only

2.2\_ S1500 Isometric view / ceiling-mounted

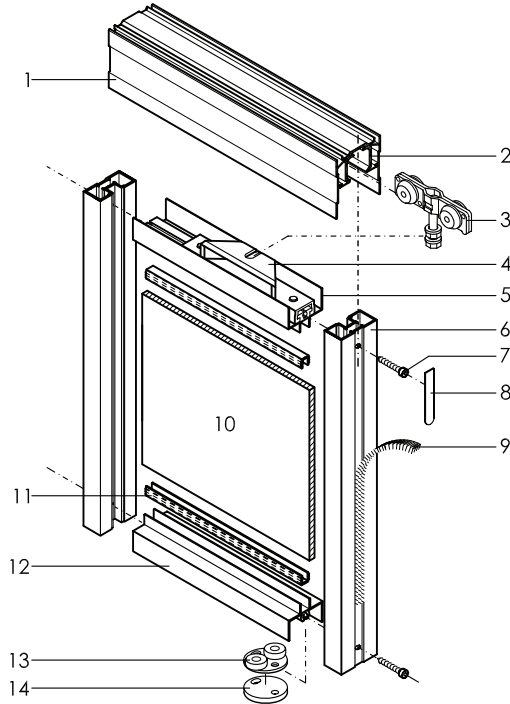
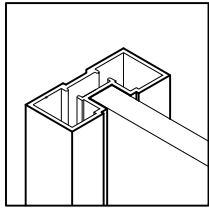

Each sliding door is composed of the following:

- Top track
- 1\_ Valance (varies by order)
- 2\_ Top track (varies by order)
- Not shown:
- AIR Stopper with brake (2)
- Door
- 3\_ AIR roller (2)
- 4\_ Fixation for top track (2)
- 5\_ Top rail (1)
- 6\_ Stile (2)
- 7\_ Frame screw (4)
- 8\_ Plug / cover (4)
- 9\_ Brush gasket (one stile only)
- 10\_ Panel (1)
- 11\_ Panel gasket (all sides of panel)
- 12\_ Bottom rail (1)
- 13\_ Ground plate with roller (1)
- 14\_ Ground plate without roller (1)

S1500 Section and stile detail / ceiling-mounted

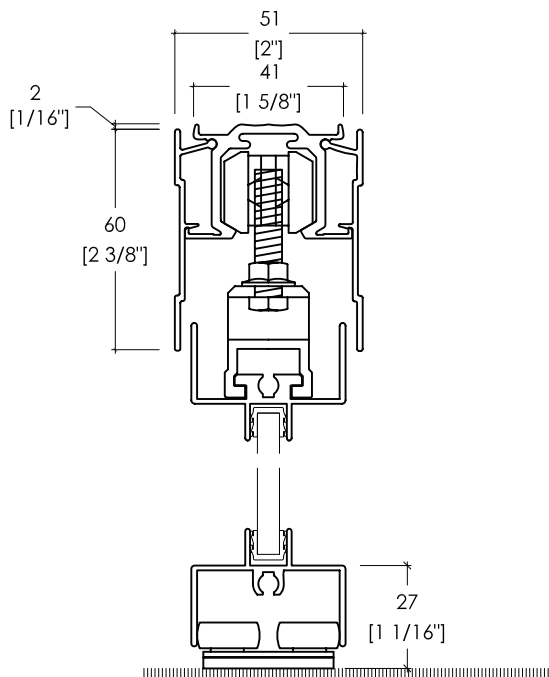

Square

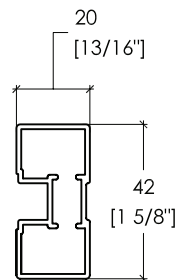

S1500 Stile

Finish  
Standard: Clear anodized aluminum (silver)

Application  
Residential / commercial projects

Dimensions  
Max size 1219mm x 2743mm [4' x 9']  
Max weight 60kg [130lbs]  
Panel thickness 4mm [3/16"] to 10mm [3/8"], 10mm without gasket  
\*Door can not travel past ground plate with roller  
Best used as single door or two bi-parting or bi-pass doors. Can be combined with fixed panels. Not recommended for larger spans

# SYSTEM DESCRIPTION\_ AIR

## SLIDING DOOR SYSTEM

### 2.3\_ S3000 Isometric view / wall-mounted

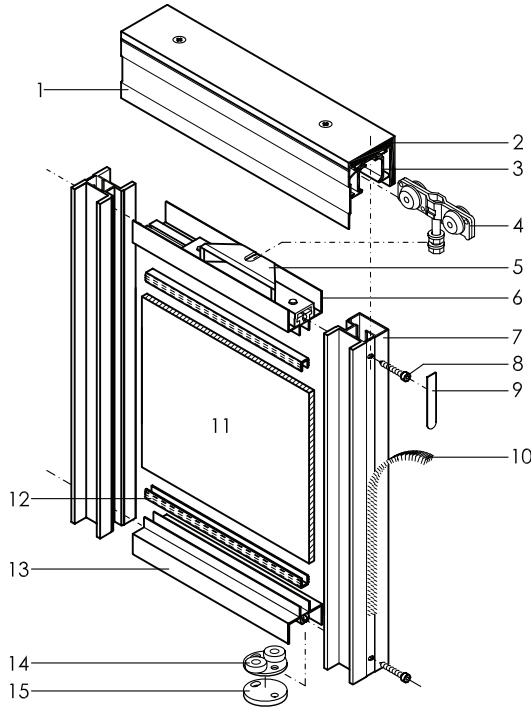
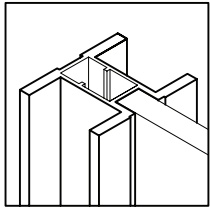

Each wall-mounted sliding door is composed of the following:

**Top track**

- 1\_ Valance (varies by order)
- 2\_ Continuous L-bracket (varies by order)
- 3\_ Top track (varies by order)

**Not shown:**

- AIR Stopper with brake (2)
- Door
- 4\_ AIR roller (2)
- 5\_ Fixation for top track (2)
- 6\_ Top rail (1)
- 7\_ Stile (2)
- 8\_ Frame screw (4)
- 9\_ Plug / cover (4)
- 10\_ Brush gasket (one stile only)
- 11\_ Panel (1)
- 12\_ Panel gasket (all sides of panel)
- 13\_ Bottom rail (1)
- 14\_ Ground plate with roller (1)
- 15\_ Ground plate without roller (1)

### S3000 Section and stile detail / wall-mounted

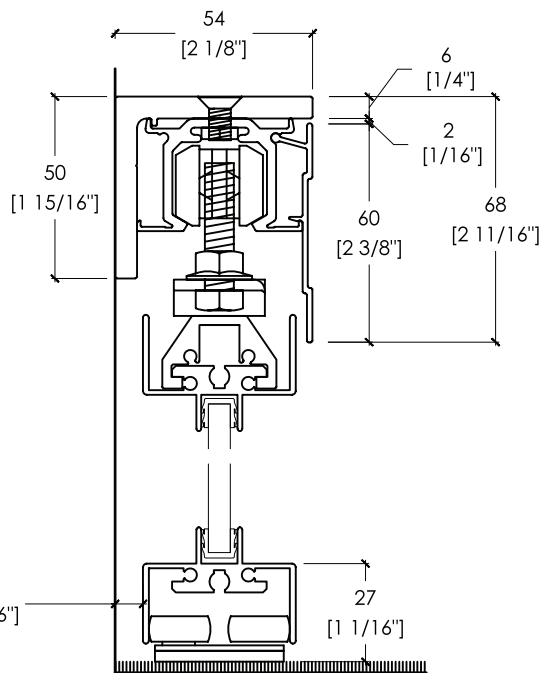

**Symmetrical**

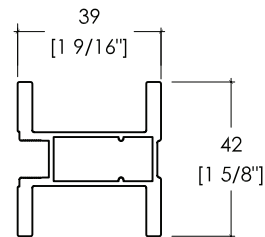

**Asymmetrical**

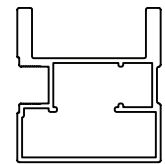

**S3000 Stile**

**Finish**

Standard: Clear anodized aluminum (silver)

**Application**

Residential / commercial projects

**Dimensions**

Max size 1219mm x 2743mm [4' x 9']

Max weight 60kg [130lbs]

Panel thickness 4mm [3/16"] to 10mm [3/8"], 10mm without gasket

\*Door can not travel past ground plate with roller

Wall-mounted, single and bi-parting doors only

2.4\_ S3000 Isometric view / ceiling-mounted

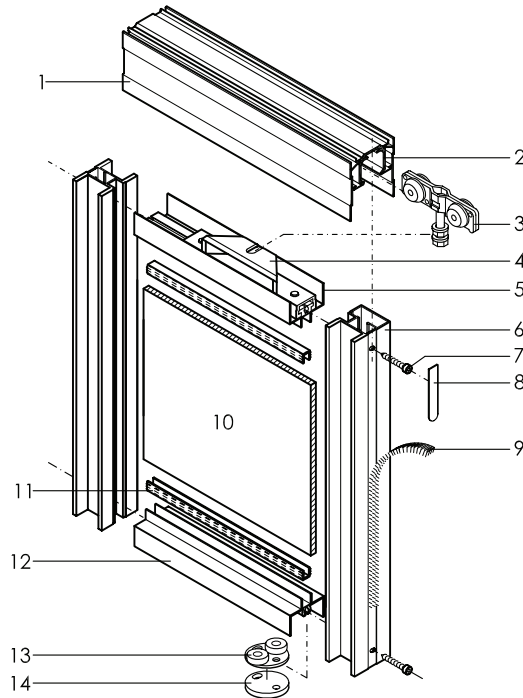
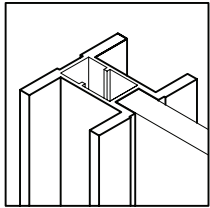

Each wall-mounted sliding door is composed of the following:

- Top track
- 1\_ Valance (varies by order)
- 2\_ Top track (varies by order)
- Not shown:
- AIR Stopper with brake (2)
- Door
- 3\_ AIR roller (2)
- 4\_ Fixation for top track (2)
- 5\_ Top rail (1)
- 6\_ Stile (2)
- 7\_ Frame screw (4)
- 8\_ Plug / cover (4)
- 9\_ Brush gasket (one stile only)
- 10\_ Panel (1)
- 11\_ Panel gasket (all sides of panel)
- 12\_ Bottom rail (1)
- 13\_ Ground plate with roller (1)
- 14\_ Ground plate without roller (1)

S3000 Section and stile detail / ceiling-mounted

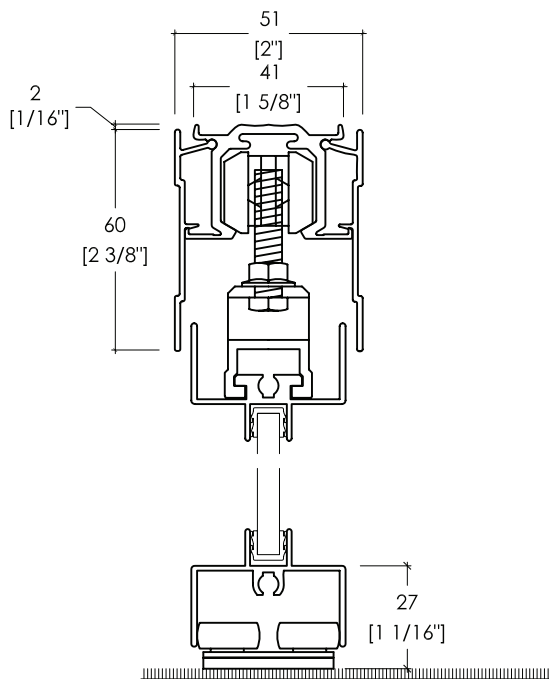

Symmetrical

Asymmetrical

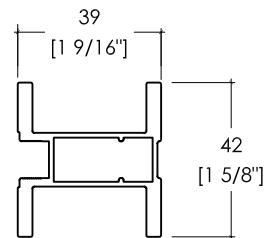

S3000 Stile

Finish  
Standard: Clear anodized aluminum (silver)

Application  
Residential / commercial projects

Dimensions  
Max size 1219mm x 2743mm [4' x 9']  
Max weight 60kg [130lbs]  
Panel thickness 4mm [3/16"] to 10mm [3/8"], 10mm without gasket  
\*Door can not travel past ground plate with roller  
Best used as single door or two bi-parting or bi-pass doors. Can be combined with fixed panels. Not recommended for larger spans

# SYSTEM DESCRIPTION\_ AIR

## SLIDING DOOR SYSTEM

### 2.5\_ AIR Solid door hardware isometric view / wall-mounted

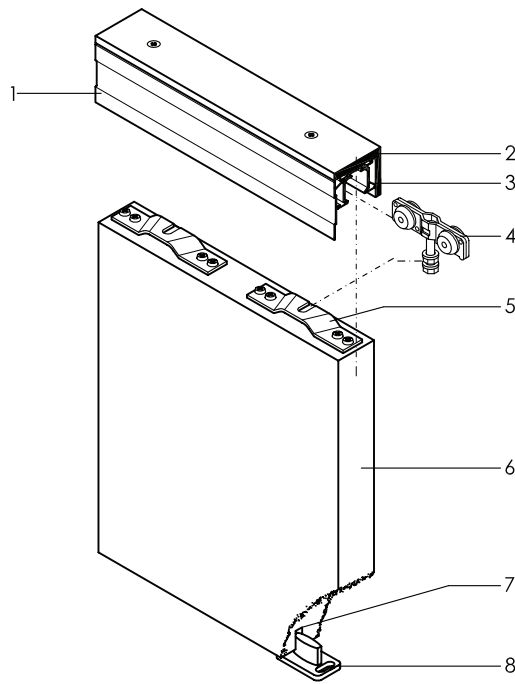
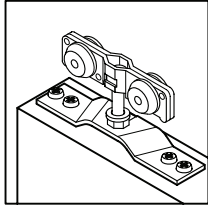

Each wall-mounted sliding door is composed of the following:

**Top track**

- 1\_ Valance (varies by order)
- 2\_ Continuous L-bracket (varies by order)
- 3\_ Top track (varies by order)

**Not shown:**

- AIR Stopper with brake (2)
- Door
- 4\_ AIR roller (2)
- 5\_ AIR bracket (2)
- 6\_ (Material by others)
- 7\_ (Cut out slot for bottom guide)
- 8\_ Solid door bottom guide (1)

### AIR Solid door hardware section and stile detail / wall-mounted

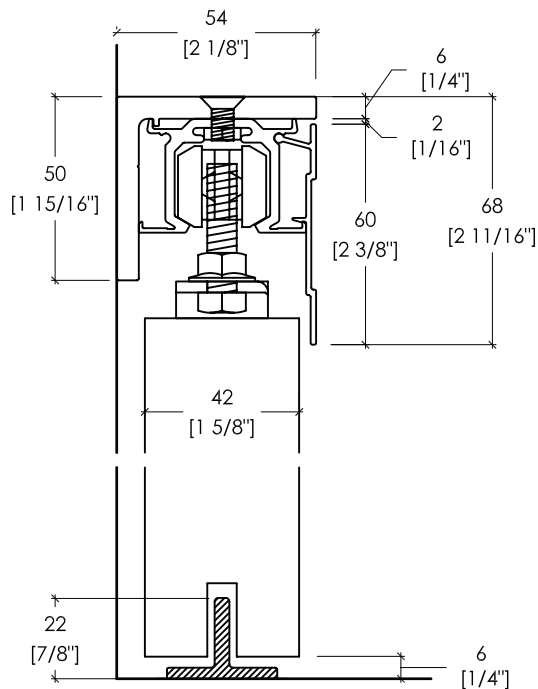

AIR Solid door hardware

**Finish**

Standard: Clear anodized aluminum (silver)

**Application**

Residential / commercial projects

**Dimensions**

Max weight 60kg [130lbs]

Panel thickness min. 38mm [1 1/2"] to max. 42mm [1 5/8"]

**Included in hardware set (one door)**

(2) AIR rollers, (2) AIR brackets, (2) AIR stoppers with brake, (1) Solid door bottom guide

\*Top track, Valance and L-bracket sold separately

Wall-mounted for single and bi-parting doors only



2.6\_ AIR Solid door hardware isometric view / ceiling-mounted

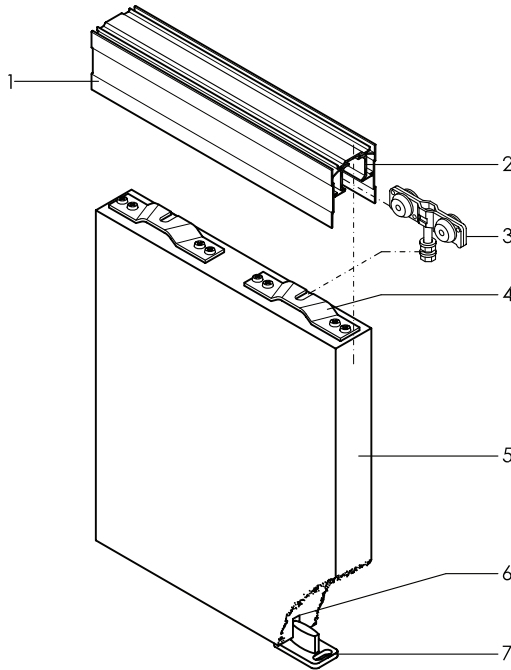
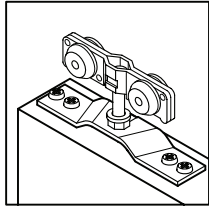

Each sliding door is composed of the following:

- Top track
- 1\_ Valance (varies by order)
- 2\_ Top track (varies by order)
- Not shown:
- AIR Stopper with brake (2)
- Door
- 3\_ AIR roller (2)
- 4\_ AIR bracket (2)
- 5\_ (Material by others)
- 6\_ (Cut out slot for bottom guide)
- 7\_ Solid door bottom guide (1)

AIR Solid door hardware section and stile detail / ceiling-mounted

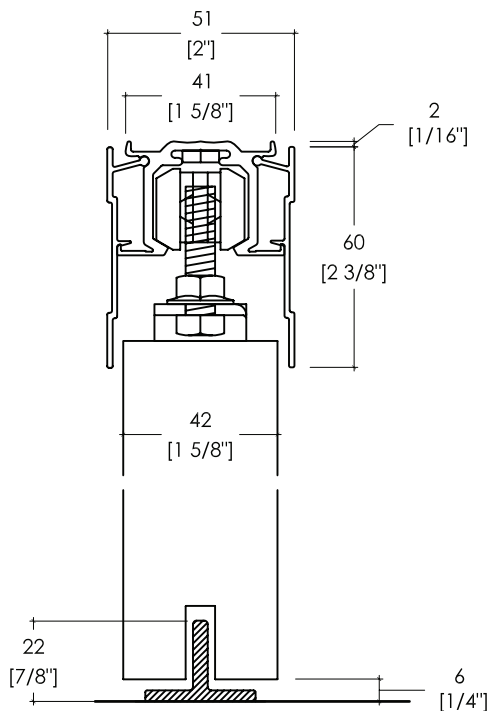

AIR Solid door hardware
Finish Standard: Clear anodized aluminum (silver)
Application Residential / commercial projects
Dimensions Max weight 60kg [130lbs] Panel thickness min. 38mm [1 1/2"] to max. 42mm [1 5/8"]
Included in hardware set (one door) (2) AIR rollers, (2) AIR brackets, (2) AIR stoppers with brake, (1) Solid door bottom guide *Top track, Valance and L-bracket sold separately Best used as single, bi-parting and bi-pass doors

# SYSTEM DESCRIPTION\_ AIR

## SLIDING DOOR SYSTEM

3_ Profile finishes				
3.1_ Standard finish _ Clear anodized aluminum (silver)				
A factory applied finish, anodizing increases wear resistance and gives the surface a smooth matte aluminum appearance. Color for representation purposes only.				
				
Standard finish Clear anodized (silver)				

## 4\_ Panels

### 4.1\_ MDF

Medium density fiberboard (MDF) is an engineered wood product made of wood fibers, wax and resin. MDF is an ideal surface for painting, application of direct glue wall-covering, or a base for upholstered panels. Maximum size 1219mm x 2438mm [4'-0" x 8'-0"]. Color for representation purposes only.



MDF  
10mm [1/4"]

### 4.2\_ Magnetic marker board

Porcelain enamel coated magnetic marker board is a white dry erase board. Maximum size 1219mm x 2743[4'-0" x 9'-0"]. Available as single or double sided. Colors for representation purposes only.





6mm [1/4"]

# SYSTEM DESCRIPTION\_ AIR

## SLIDING DOOR SYSTEM

### 4.3\_ Laminated glass

Laminated glass, often referred to as "safety glass", is strong and durable and designed to maintain its integrity in the event of breakage. Maximum size 1219mm x 2743mm [4' x 9']. Colors for representational purposes only. May contain glass manufacturer safety mark

				
Clear 6mm [1/4"]	Diffused white 6mm [1/4"]			

### 4.4\_ Tempered glass

Tempered glass is manufactured to exact size and is stronger than regular glass. If broken the glass shatters into small fragments instead of sharp shards. Maximum size 1219mm x 2743mm [4'-0" x 9'-0"]. Colors for representation purposes only. Manufactures glass bug in corner of glass

				
Clear 6mm [1/4"]	Satin etched 6mm [1/4"]			

### 4.5\_ Mirrored glass

Silver mirror backed with a safety film. Single-sided mirror only, best used for closets. Maximum size 1219mm x 2743mm [4'-0" x 9'-0"]. Colors for representation purposes only.

				
Mirror 5mm [3/16"]				

## 5\_ Top tracks

### 5.1\_ AIR Top track

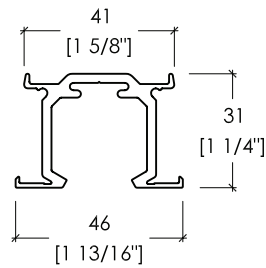
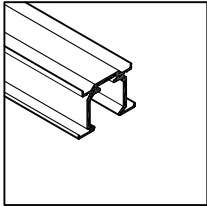

14.55.020

AIR Top track

Finish  
Standard

Description  
Ceiling- or wall-mounted (add continuous L-bracket and wall-mounted end caps)  
Max length 4877mm [16'-0"]  
Note: If recessing top track please allow an additional 5" width for adjustment of doors.

### 5.2\_ AIR Valance

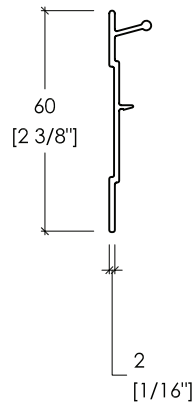
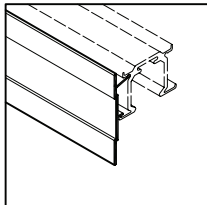

14.50.020

AIR Valance

Finish  
Standard

Description  
Use on one or both sides of track  
Max length 4877mm [16'-0"]

### 5.3\_ AIR Continuous L-bracket

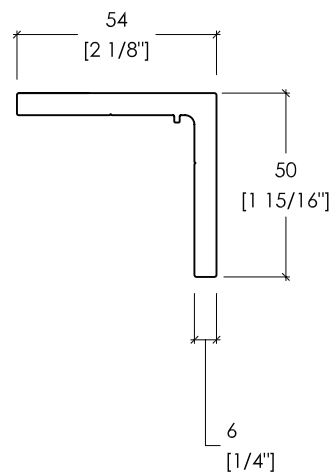
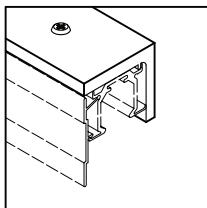

14.54.020

AIR Continuous L-bracket

Finish  
Standard

Description  
Wall-mounted bracket for AIR Top track  
Prepared for assembly, includes track-to-bracket fasteners  
Max length 4877mm [16'-0"]  
Wall-mount for single doors only

# SYSTEM DESCRIPTION\_ AIR

## SLIDING DOOR SYSTEM

### 5.4\_ AIR Middle valance

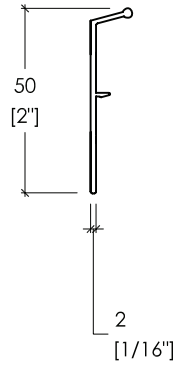
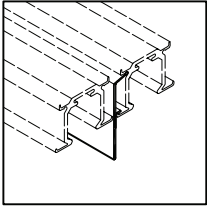

14.53.020

AIR Middle valance

Finish  
Standard

Description  
Optional: Use between AIR tracks  
Max length 4877mm [16'-0"]

## 6\_ Accessories

### 6.1\_ AIR End cap for top track / ceiling-mounted

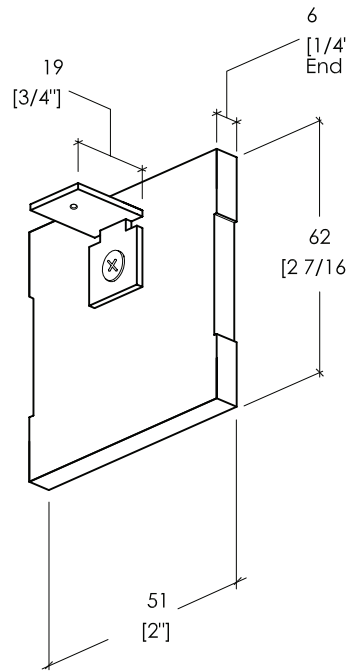
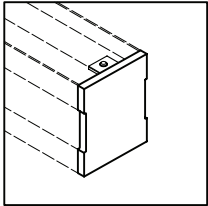

ACC-AIR-ECB

AIR End cap for single top track / ceiling-mounted

Finish  
Standard

Description  
For ceiling-mounted top tracks  
Includes (1) single end cap  
(1) bracket, (1) bracket-to-end cap  
screw, and (1) set screw

### 6.2\_ AIR End cap for top track / wall-mounted, left

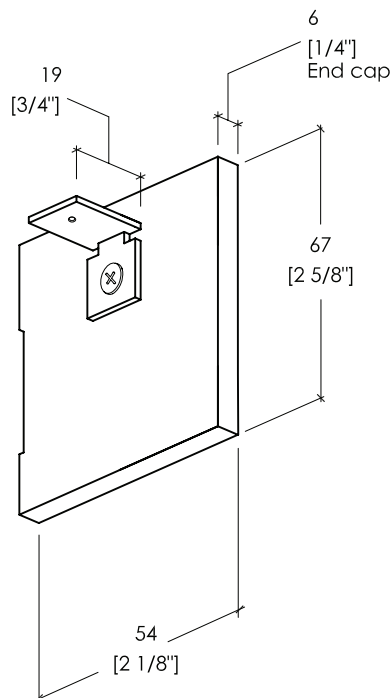
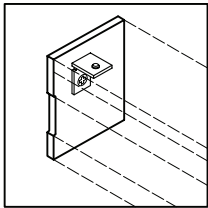

ACC-AIR-ECL

AIR End cap for top track / wall-mounted, left

Finish  
Standard

Description  
For wall-mounted top tracks  
Includes (1) single end cap  
(1) bracket, (1) bracket-to-end cap  
screw, and (1) set screw

# SYSTEM DESCRIPTION\_ AIR

## SLIDING DOOR SYSTEM

### 6.3\_ AIR End cap for top track / wall-mounted, right

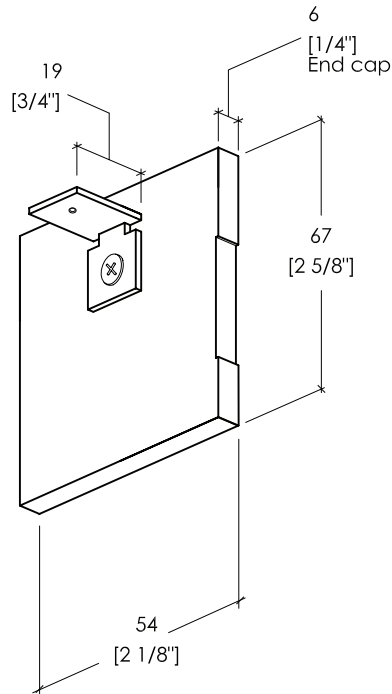
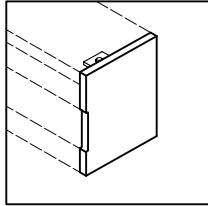

ACC-AIR-ECR

AIR End cap for top track / wall-mounted, right

Finish  
Standard

Description  
For wall-mounted top tracks  
Includes (1) single end cap,  
(1) bracket, (1) bracket-to-end cap  
screw, and (1) set screw

### 6.4\_ AIR Stopper with brake

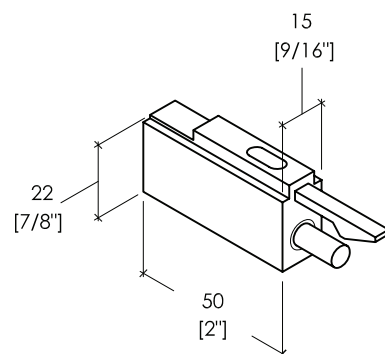
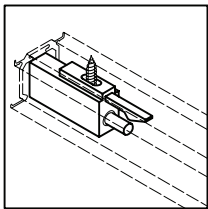

10.05.017

AIR Stopper with brake

Finish  
Black plastic

Description  
Used for stopping door and  
holding in the closed position  
Includes 1 mounting screw



6.5\_ AIR Stopper with positioner

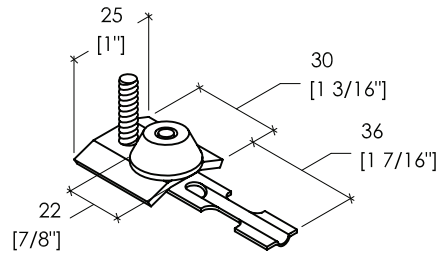
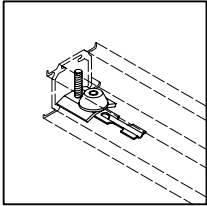

10.05.015
AIR Stopper with positioner
Finish Steel and black rubber
Description May be used in place of AIR Stopper with brake *Standard stopper for Healthcare

6.6\_ AIR Brake

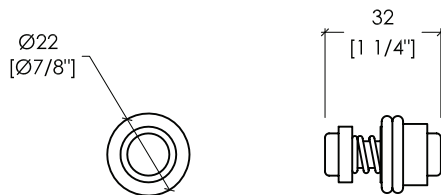
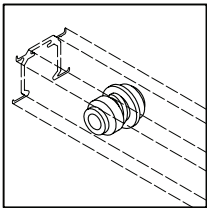

10.05.030
AIR Brake
Finish Black plastic
Description Used between top rollers to slow doors over 41 kilo [90 lbs] *Standard brake for Healthcare

6.7\_ AIR Ground plate with roller

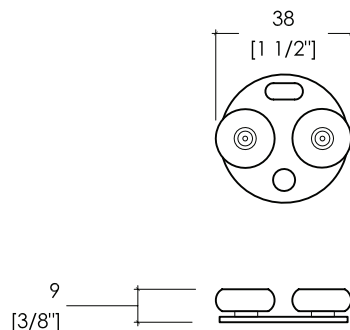
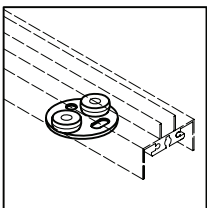

10.06.030
AIR Ground plate with roller
Finish Steel and nylon
Description Concealed under bottom rail, keeps door in line Floor fasteners not included * Door can not travel past ground plate with roller * See 7_ Diagram Alignment

# SYSTEM DESCRIPTION\_ AIR

## SLIDING DOOR SYSTEM

### 6.8\_ AIR Ground plate without roller

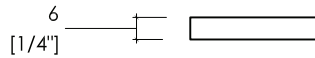
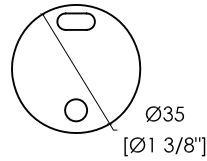
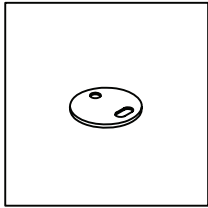

10.05.025

AIR Ground plate without roller

Finish  
Steel

Description  
Used as shim beneath AIR Ground plate with roller

### 6.9\_ AIR Break-away guide

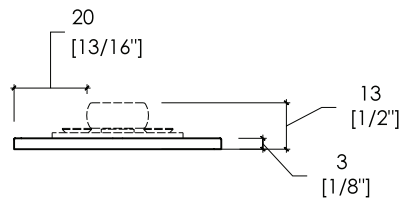
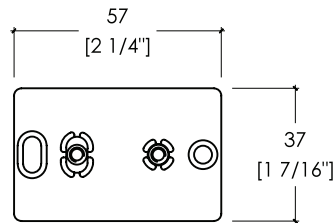
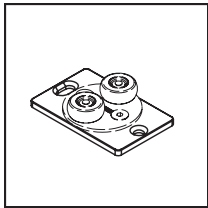

10.06.032

AIR Break-away guide

Finish  
Grey plastic

Description  
Break-away shim used beneath AIR ground plate with roller.  
OSPHD approved  
\*Door can not travel past ground plate with roller

### 6.10\_ AIR Break-away guide

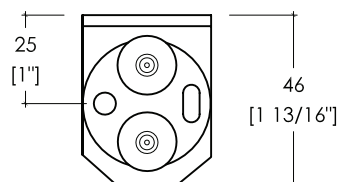
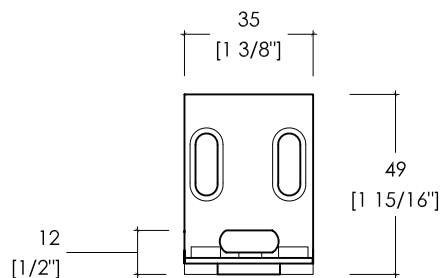
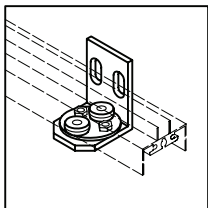

10.05.022

AIR Wall-mounted ground plate with roller

Finish  
Aluminum

Description  
Used when ground plate may not be attached to floor  
\*Door can not travel past ground plate with roller  
\* See 7\_ Diagram Alignment

6.11\_ AIR S1500 Ganging device, left

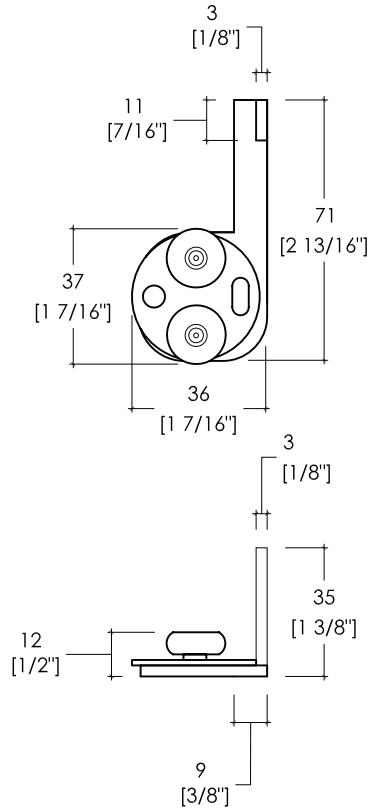
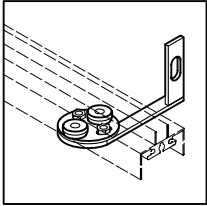

10.05.170

AIR S1500 Ganging device, left

Finish  
Steel and nylon

Description  
Gangs one door to another door hanging from a second track  
Limited to two doors ganged together  
\* See 7\_ Diagram Alignment

6.12\_ AIR S1500 Ganging device, right

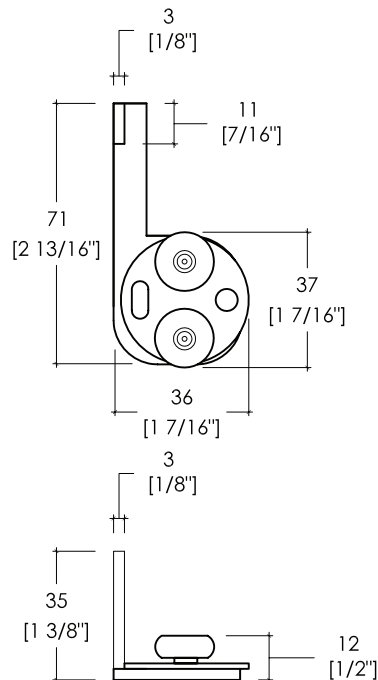
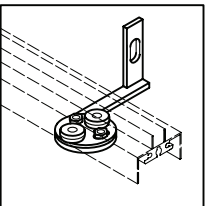

10.05.171

AIR S1500 Ganging device, right

Finish  
Steel and nylon

Description  
Gangs one door to another door hanging from a second track  
Limited to two doors ganged together  
\* See 7\_ Diagram Alignment

# SYSTEM DESCRIPTION\_ AIR

## SLIDING DOOR SYSTEM

System description\_ AIR\_ S1500, S3000, Solid Door hardware

Sliding door system

6.13\_ AIR S3000 Ganging device, left

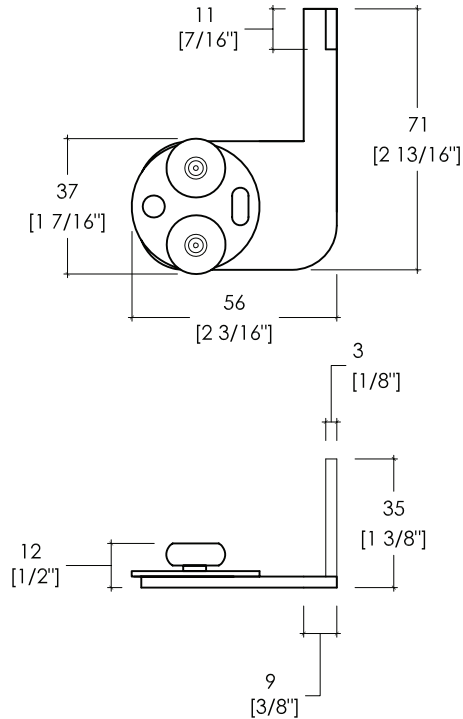
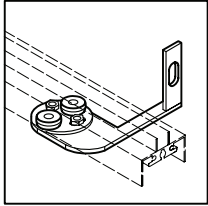

10.05.172

AIR S3000 Ganging device, left

Finish  
Standard

Description  
Gangs one door to another door  
hanging from a second track  
Limited to two doors ganged  
together  
\* See 7\_ Diagram Alignment

6.14\_ AIR S3000 Ganging device, right

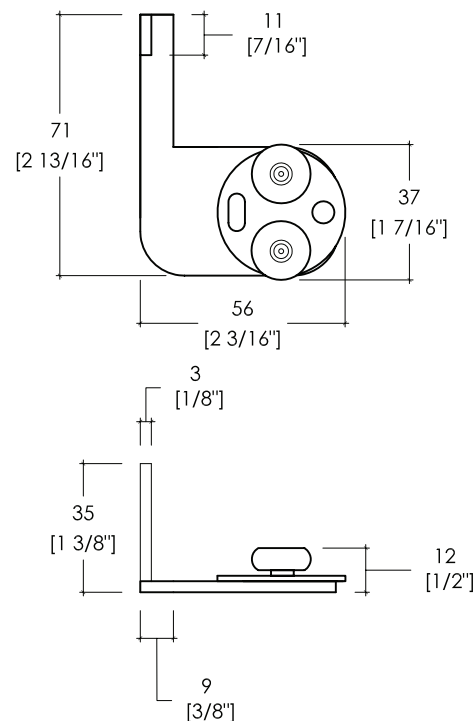
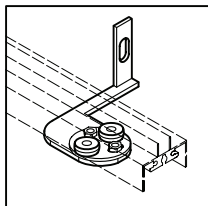

10.05.173

AIR S3000 Ganging device, right

Finish  
Steel and nylon

Description  
Gangs one door to another door  
hanging from a second track  
Limited to two doors ganged  
together  
\* See 7\_ Diagram Alignment

6.15\_ AIR Synchro



10.06.060
AIR Synchro
Finish Steel and plastic
Description Concealed pulley system which enables two doors on same track to be opened or closed simultaneously by pulling on just one door. * Bi-parting doors only

6.16\_ 45° Corner profile

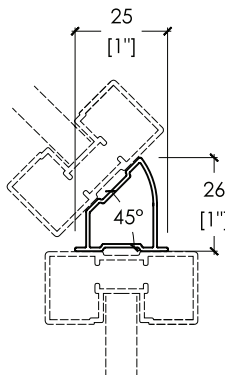
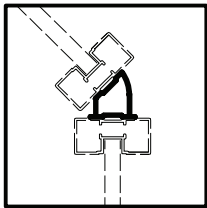

14.07.020
45° Corner profile
Finish Standard
Description Provided with adhesive backing

6.17\_ 90° Corner profile

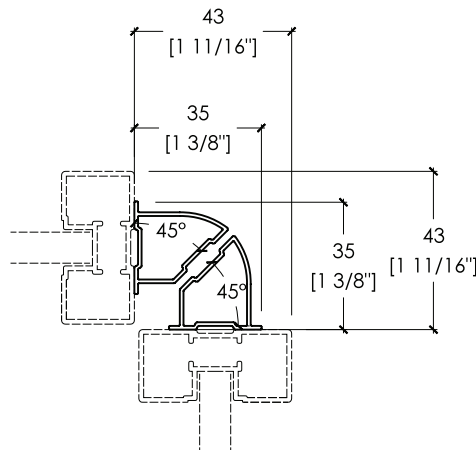
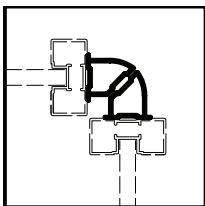

14.07.020
90° Corner profile
Finish Standard
Description Provided with adhesive backing

# SYSTEM DESCRIPTION\_ AIR

## SLIDING DOOR SYSTEM

### 6.18\_ Square with circle cut-out applied handle

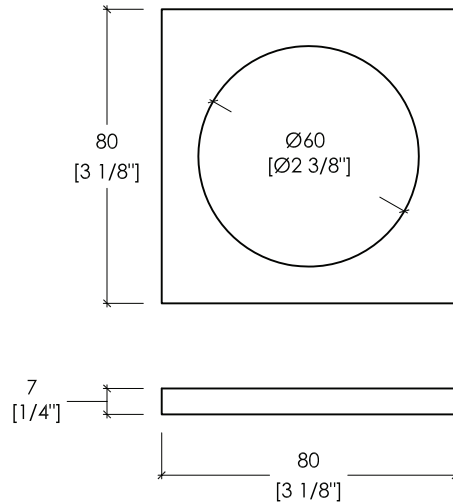
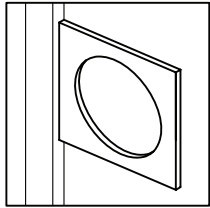

10.02.091

Square with circle cut-out applied handle

Finish  
Standard

Description  
Provided with adhesive backing which requires on-site trimming

### 6.19\_ Pocket pull

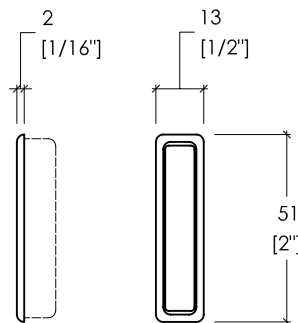
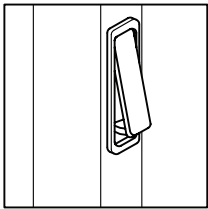

10.01.047

Pocket pull

Finish  
Standard

Description  
Used with pocket doors

### 6.20\_ Rod handle for S1500 square

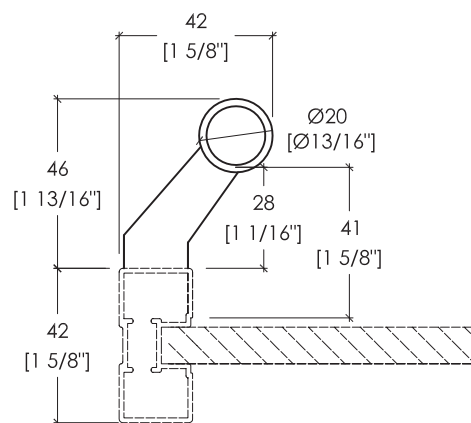
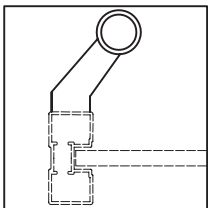

ACC-RDH-1500SQ

Rod handle for S1500 Square

Finish  
Standard

Description  
Adds vertical rod handle to S1500 Square  
\*Includes plastic silver end caps  
\*Available in 305mm [1'-0"]  
\*Can only be used with S1500  
\*Available in 305mm [1'-0"]  
intruments

6.21\_ Rod handle for S3000

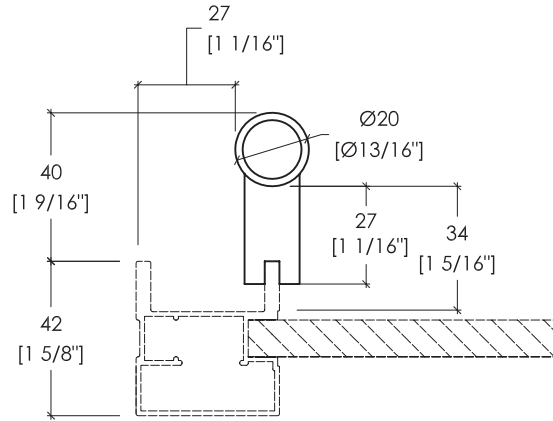
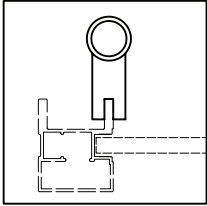

ACC-RDH-3000  
Rod handle for S3000

Finish  
Standard

Description  
Adds vertical rod handle to S3000  
\*Includes plastic silver end caps  
\*Available in 305mm [1'-0"]  
\*Can only be used with S3000  
\*Available in 305mm [1'-0"]  
intrements

6.22\_ ADA handle for S3000

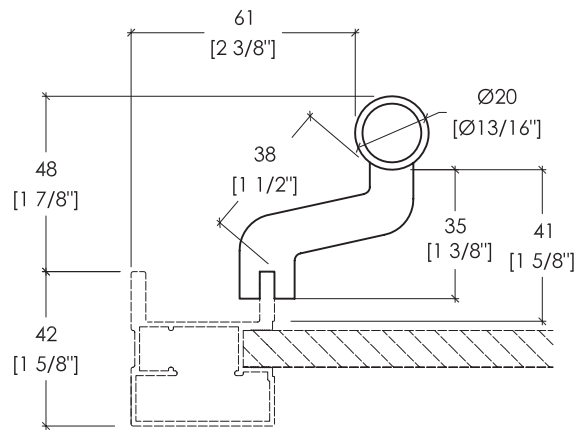
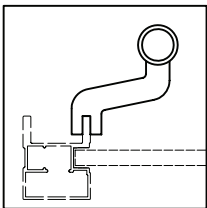

ACC-RDH-ADA  
ADA handle for S3000

Finish  
Standard

Description  
ADA bracket with rod handle  
complies with ADA requirements  
for sliding door handles, verify with  
local jurisdictions  
\*Includes plastic silver end caps  
\*Can only be used with S3000  
profile  
\*Available in 305mm [1'-0"]  
intrements

6.23\_ Post

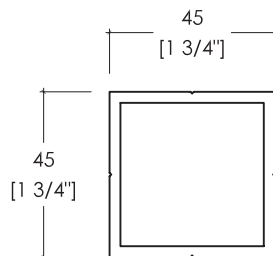
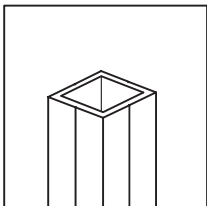

ACC-ST-20

Post

Finish  
Standard

Description  
on supporting. Use in conjunction  
with lock, corner or jamb.  
Max length 3048mm [10'-0"]  
Includes 3 mounting blocks

# SYSTEM DESCRIPTION\_ AIR

## SLIDING DOOR SYSTEM

### 6.24\_ Half rectangle applied handle

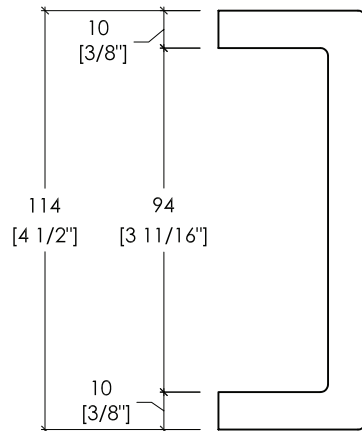
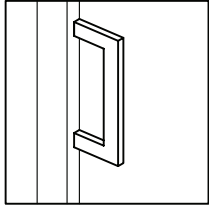

10.01.093

Half rectangle applied handle

Finish  
Standard

Description  
Provided with adhesive backing



6.26\_ Frame lock for S3000

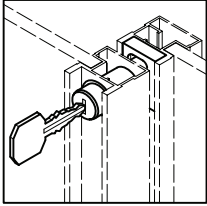

Symmetrical

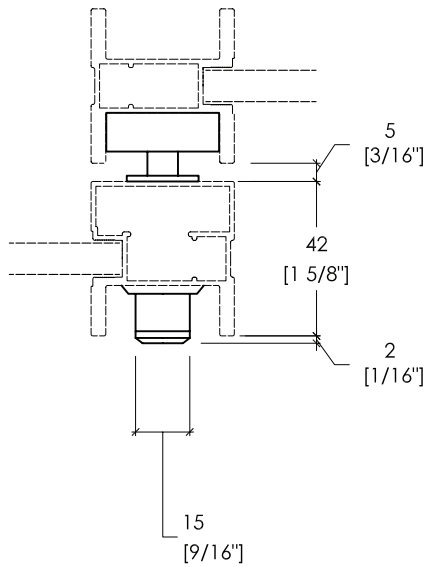

Asymmetrical

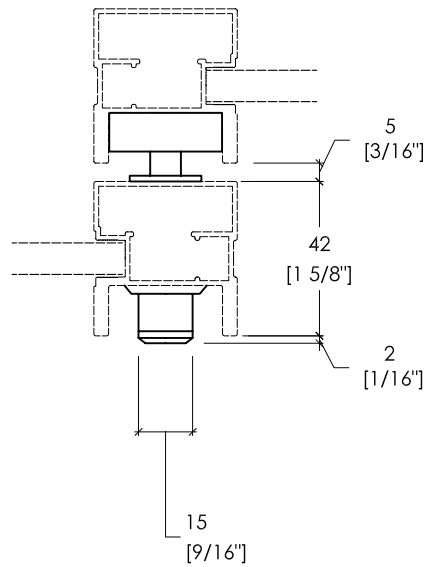

ACC-FLK-3000

Frame lock for S3000

Finish  
Standard

Description  
Locks S300 asymmetrical stile to S300 stile of choice  
Allows multiple panels to be locked together.  
Specify symmetrical or asymmetrical for second stile  
Includes S300 Lock plate (10.01.153)  
Key cylinder is by ABUS.  
Blank keys are available from raumplus.  
Cylinders are not compatible with Schlage.  
Locks not suitable for healthcare environments.  
Best suited for closets.  
\* Please check with local building code for egress

# SYSTEM DESCRIPTION\_ AIR

## SLIDING DOOR SYSTEM

6.27\_ Panel Lock, thumb-turn for S1500

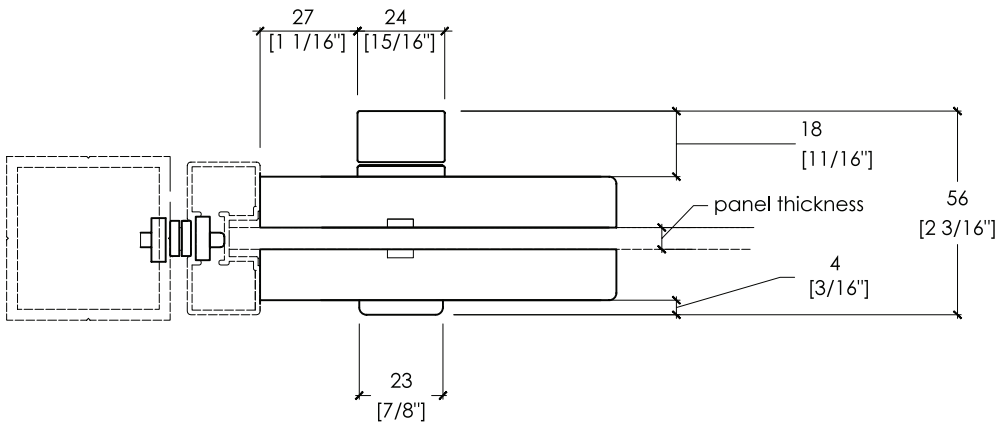
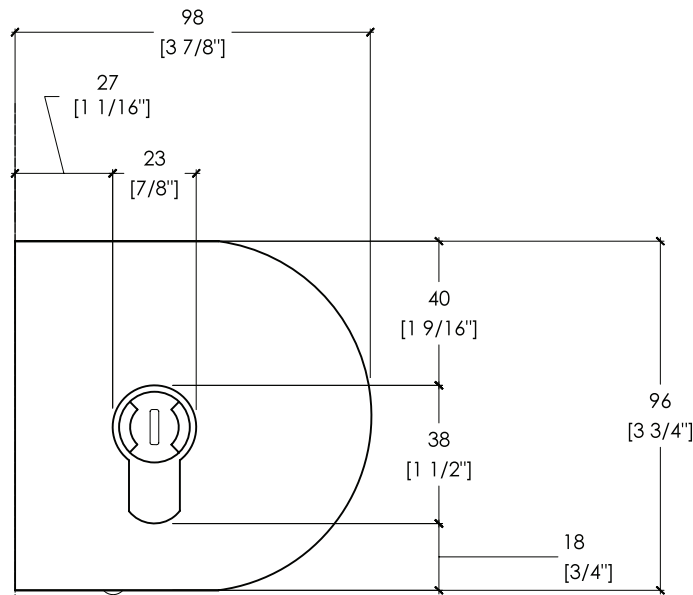
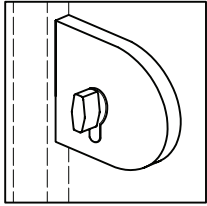

ACC-PLT-1500

Panel Lock for S1500

Finish  
Standard

Description  
Locks two bi-parting panels together on the same track, (must have center stop in top track) or one panel to jamb or post. Key cylinder is by ABUS. Blank keys are available from raumplus. Cylinders are not compatible with Schlage.  
\* Please check with local building code for egress

6.28\_ Panel Lock, key-lock for S1500

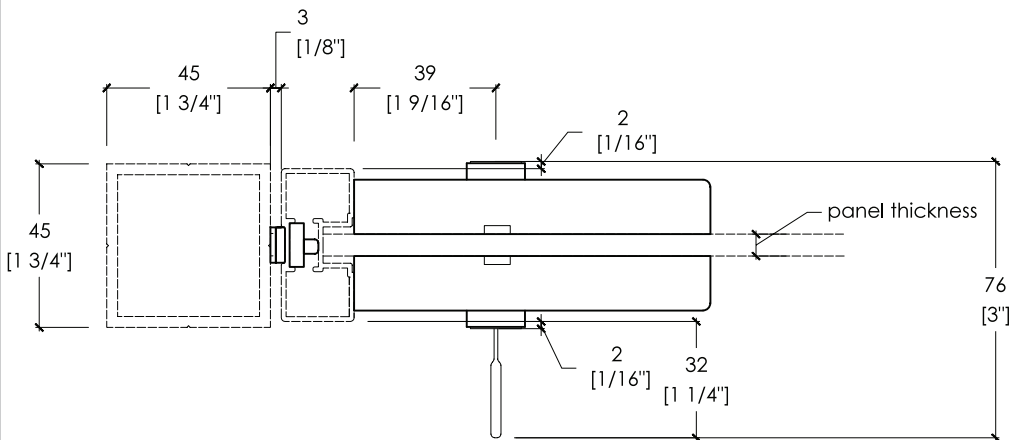
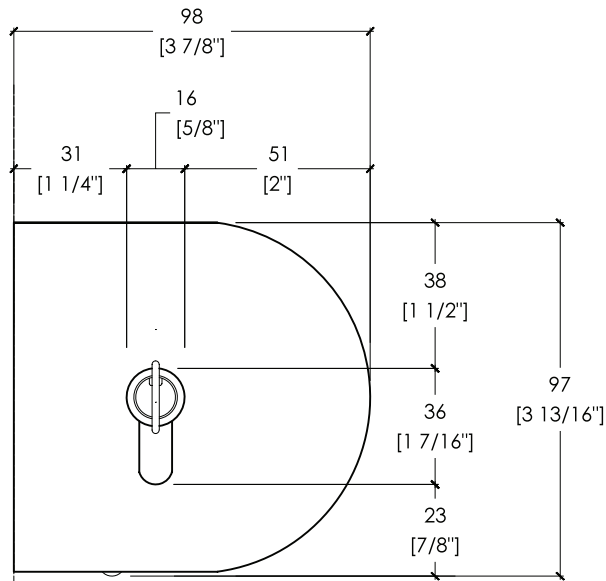
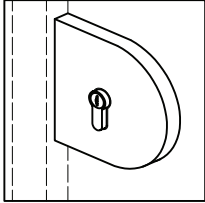

ACC-PLK-1500

Panel Lock for S1500

Finish  
Standard

Description  
Locks two bi-parting panels together on the same track, (must have center stop in top track) or one panel to jamb or post. Key cylinder is by ABUS. Blank keys are available from raumplus. Cylinders are not compatible with Schlage.  
\* Please check with local building code for egress

# SYSTEM DESCRIPTION\_ AIR

## SLIDING DOOR SYSTEM

6.29\_ Panel Lock, thumb-turn for S3000

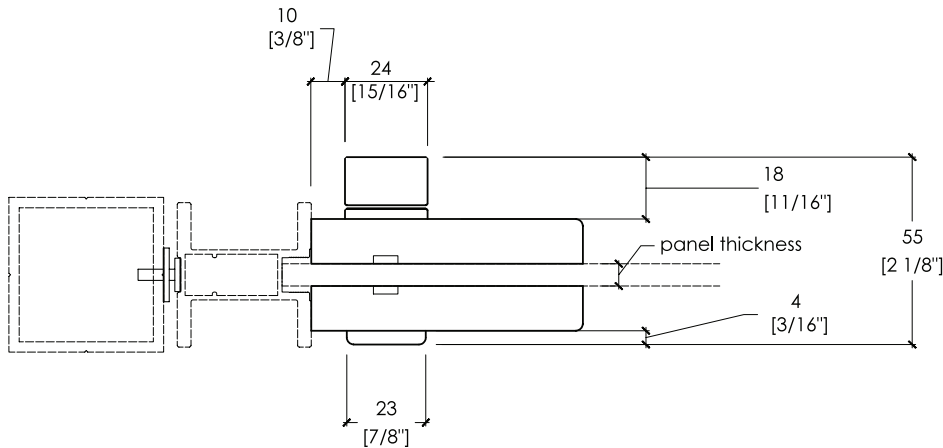
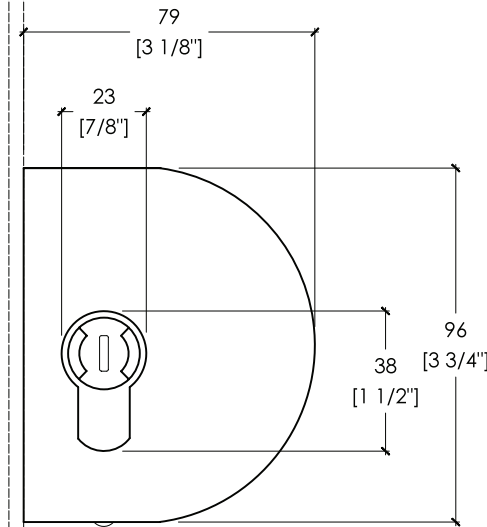
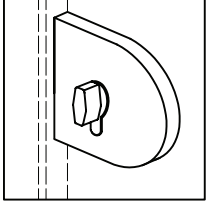

ACC-PLT-3000

Panel Lock for S3000

Finish  
Standard

Description  
Locks two bi-parting panels together on the same track, (must have center stop in top track) or one panel to jamb or post. Key cylinder is by ABUS. Blank keys are available from raumplus. Cylinders are not compatible with Schlage.  
\* Please check with local building code for egress

6.30\_ Panel Lock, key-lock for S3000

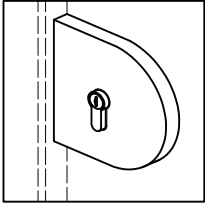

ACC-PLK-3000

Panel Lock for S3000

Finish  
Standard

Description  
Locks two bi-parting panels together on the same track, (must have center stop in top track) or one panel to jamb or post. Key cylinder is by ABUS. Blank keys are available from raumplus. Cylinders are not compatible with Schlage.  
\* Please check with local building code for egress

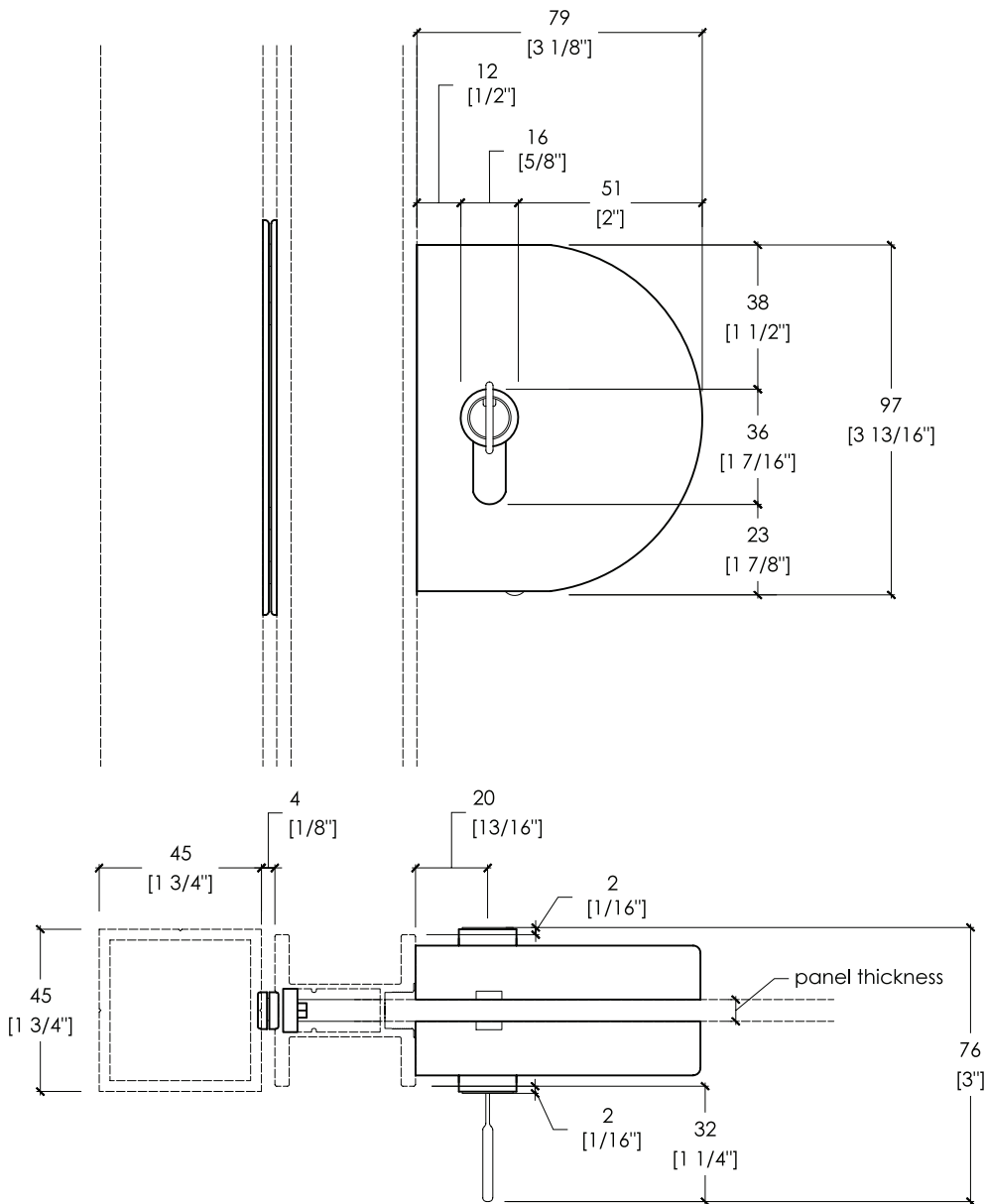

# SYSTEM DESCRIPTION\_ AIR

## SLIDING DOOR SYSTEM

### 6.31\_ True dividing rail

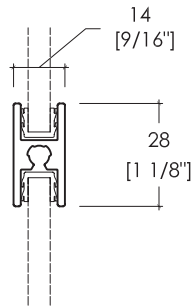
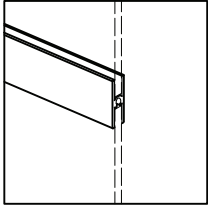

13.22.020

True dividing rail

Finish  
Standard

Description  
Use to partition different materials horizontally or \*vertically within a door  
\*Consult Raumplus for vertical partitioning, cannot combine horizontal and vertical true dividers within one door  
Note: Frame kits not drilled for dividers

### 6.32\_ Single-sided applied dividing rail

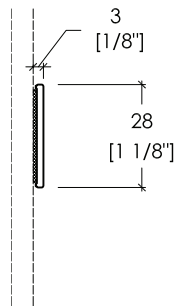
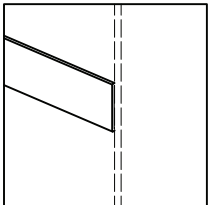

13.33.020

Single-sided applied dividing rail

Finish  
Standard

Description  
Provided with adhesive backing  
Applied divider can be used horizontally or vertically

### 6.33\_ Double-sided applied dividing rail

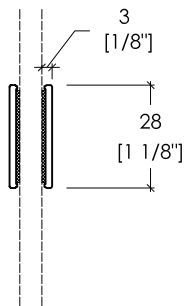
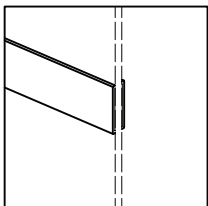

13.33.020

Double-sided applied dividing rail

Finish  
Standard

Description  
Provided with adhesive backing  
Applied divider can be used horizontally or vertically

6.34\_ Brush gasket

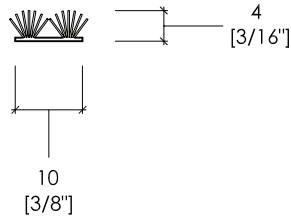
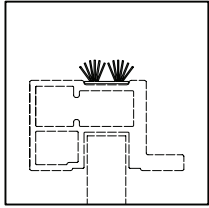

10.07.023 (2.6m)  
10.07.024 (3m)

Brush gasket

Finish  
Grey

Description  
Used to cushion against wall, door or post  
One side standard, per door  
Includes two clips  
\*2.6m [8'-6 3/8"]  
3m [9'-10 1/8"]

6.35\_ Rubber gasket

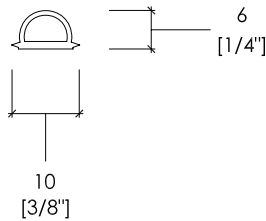
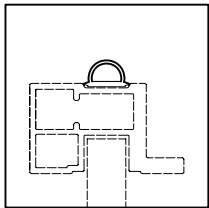

10.26.070

Rubber gasket

Finish  
Grey

Description  
Used to cushion against wall, door or post  
Specify if substituting for standard brush gasket  
\*Cut to order

# SYSTEM DESCRIPTION\_ AIR

## SLIDING DOOR SYSTEM

### 7\_ Diagrams\_Alignment

#### 7.1\_S1500 Alignment options / wall-mounted, typical and oversized overlap

Typical overlap

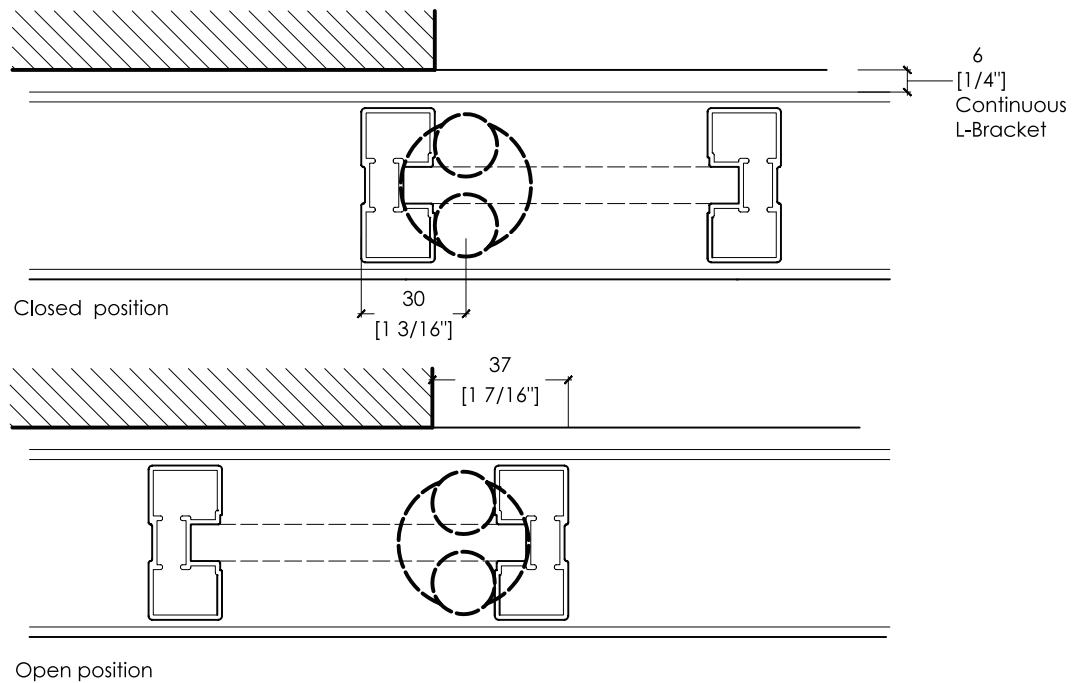

Oversized overlap

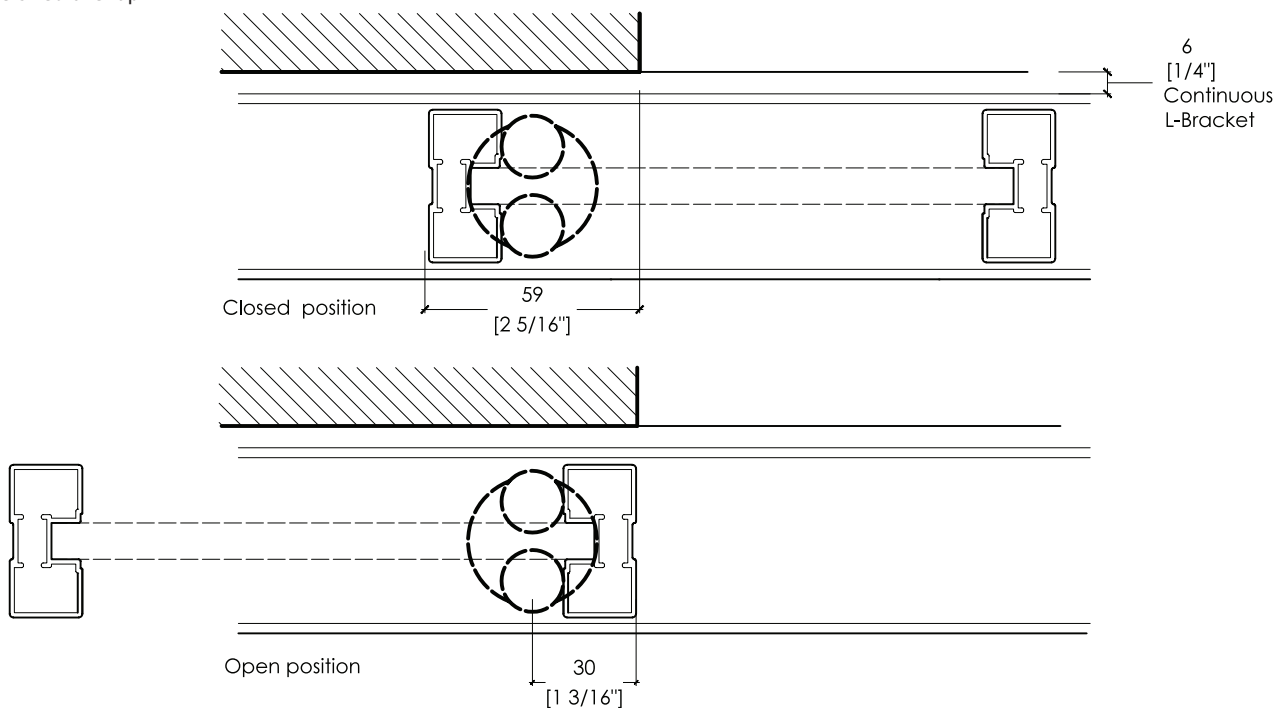

NOTE: Door can not travel past floor guide. To clear opening you must oversize the door.



### 7.2\_ S1500 Alignment / offset bypass

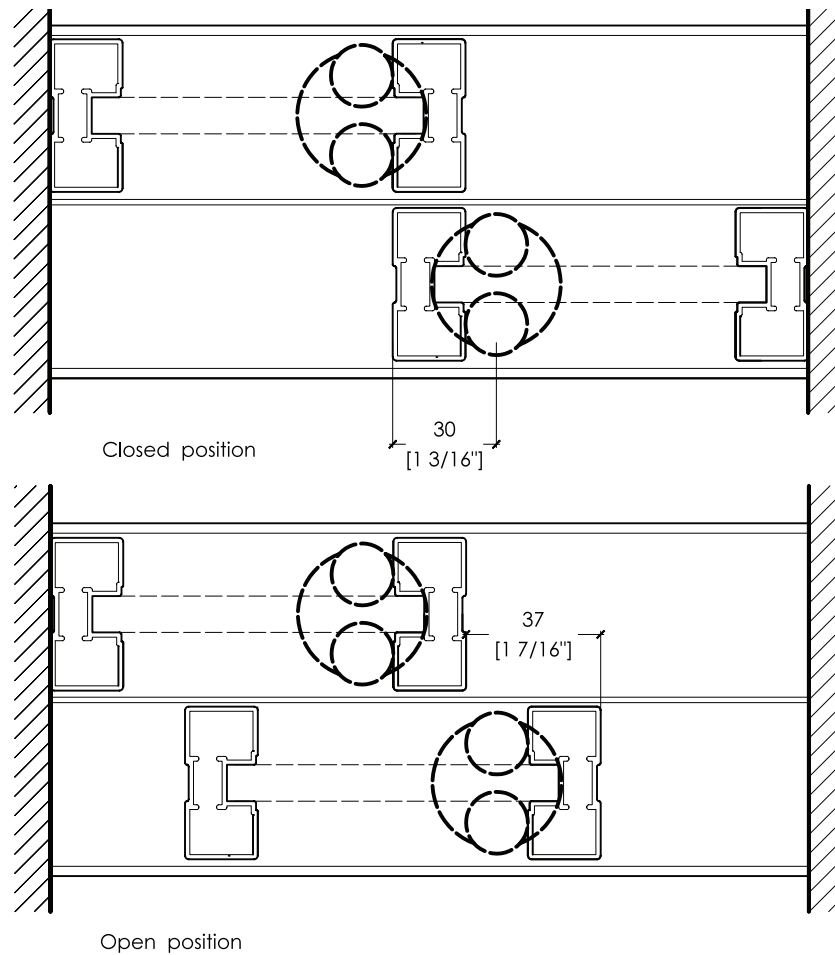

### 7.3\_ S1500 Alignment notes

Each AIR door is held in vertical plane at three points: the two top rollers and the ground plate with roller (floor guide).

For wall-mounted doors, with a typical overlap (one stile each side of opening) the door will project into the opening by 37mm [1 7/16"] when in the open position. To fully clear the opening, a door must be oversized with an overlap on one side at a minimum of 59mm [2 5/16"]. For a symmetrical overlap the amount of the overlap must be doubled. These rules apply to single ceiling- or wall-mounted doors.

If installing as a pocket door with pre-shipped tracks please specify that the rollers ship with the tracks. The rollers must be in the tracks before the tracks are installed.

\* Door can not travel past floor guide. To clear opening you must oversize the door.

# SYSTEM DESCRIPTION\_ AIR

## SLIDING DOOR SYSTEM

### 7.4\_ S3000 Alignment options / wall-mounted, typical and oversized overlap

Typical overlap

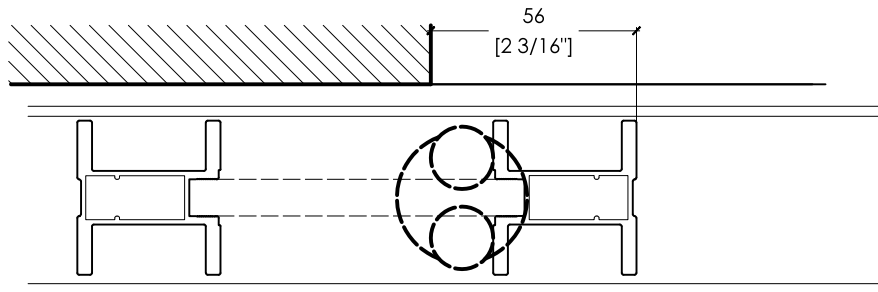
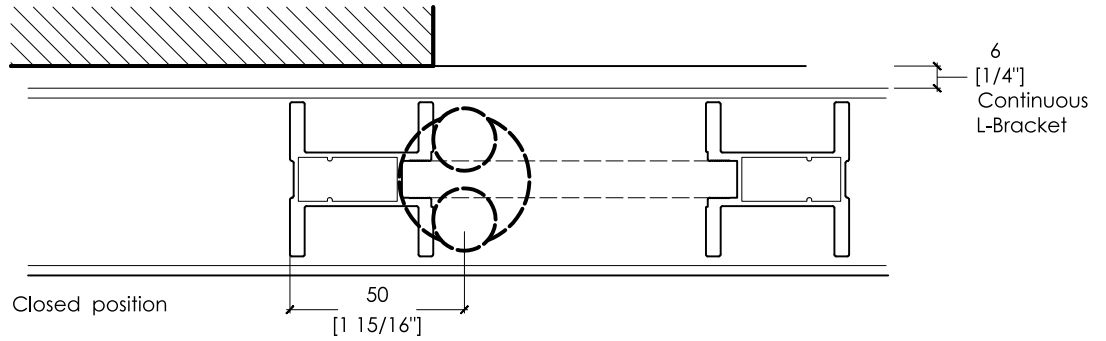

Open position

Oversized overlap

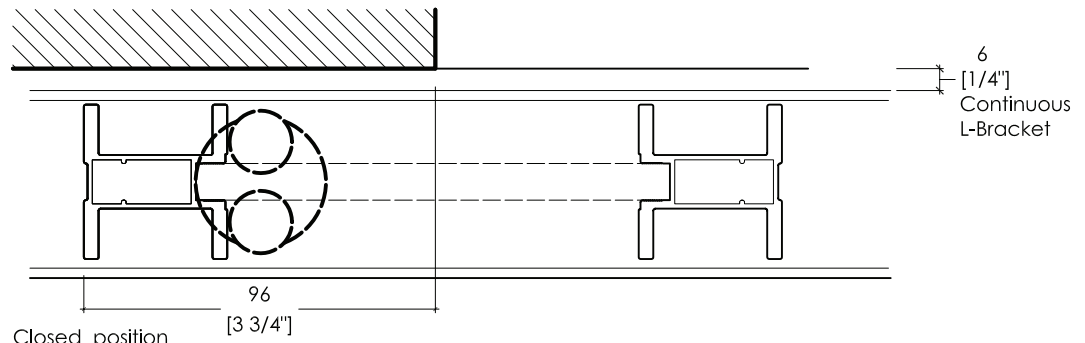

Closed position

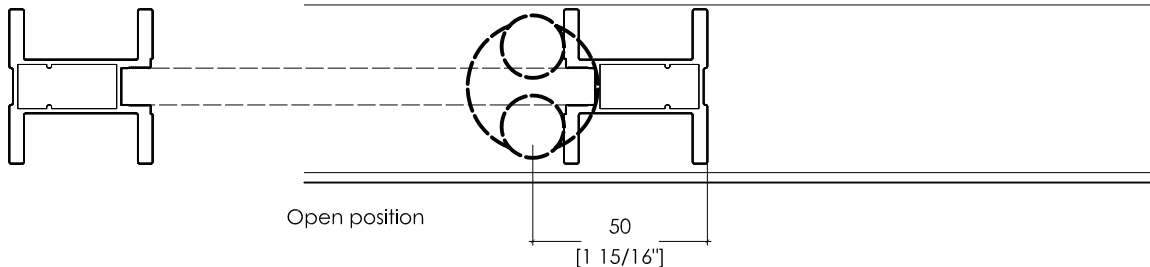

Open position

NOTE: Door can not travel past floor guide. To clear opening you must oversize the door.

### 7.5\_ S3000 Alignment / offset bypass

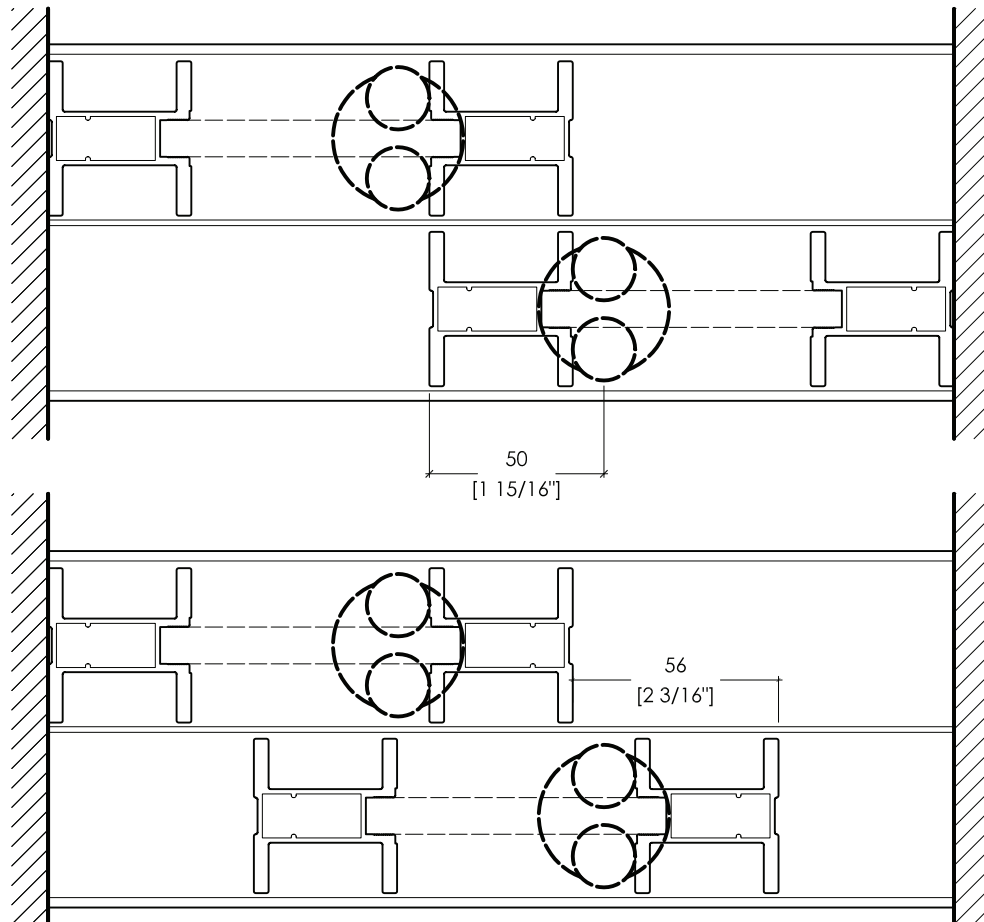

### 7.6\_ S3000 Alignment notes

Each AIR door is held in vertical plane at three points: the two top rollers and the ground plate with roller (floor guide).

For wall-mounted doors, with a typical overlap (one stile each side of opening) the door will project into the opening by 37mm [2 7/16"] when in the open position. To fully clear the opening, a door must be oversized with an overlap on one side at a minimum of 96mm [3 3/4"]. For a symmetrical overlap the amount of the overlap must be doubled. These rules apply to single ceiling- or wall-mounted doors.

If installing as a pocket door with pre-shipped tracks please specify that the rollers ship with the tracks.  
The rollers must be in the tracks before the tracks are installed.

# SYSTEM DESCRIPTION\_ AIR

## SLIDING DOOR SYSTEM

### 8\_Diagrams\_Ganging

#### 8.1\_S1500 Ganging / double, left

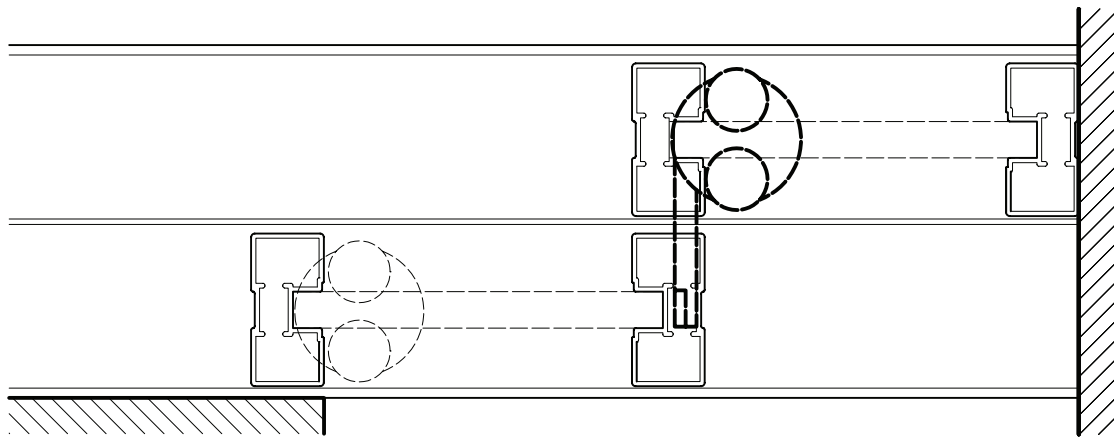

Closed position

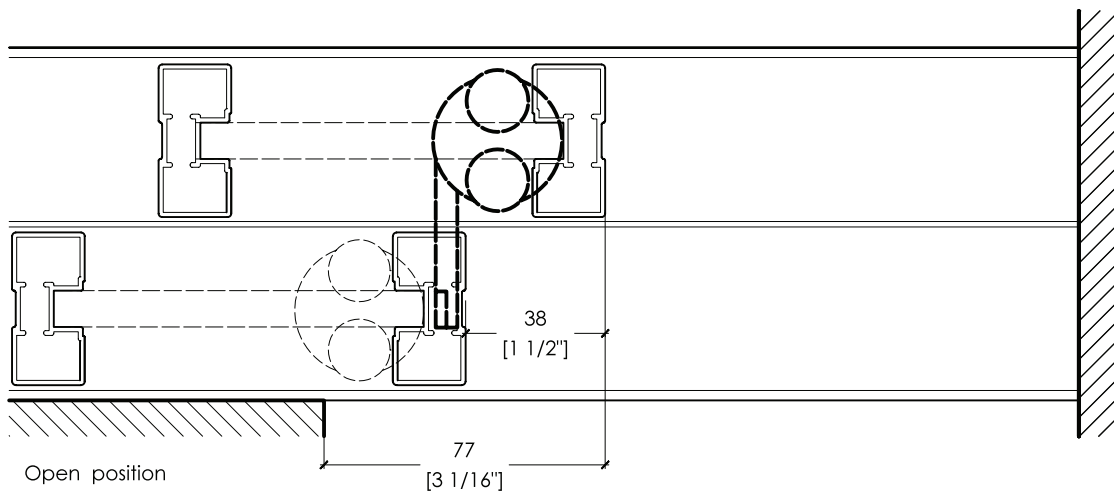

Open position

### 8.2\_ S1500 Ganging / double, right

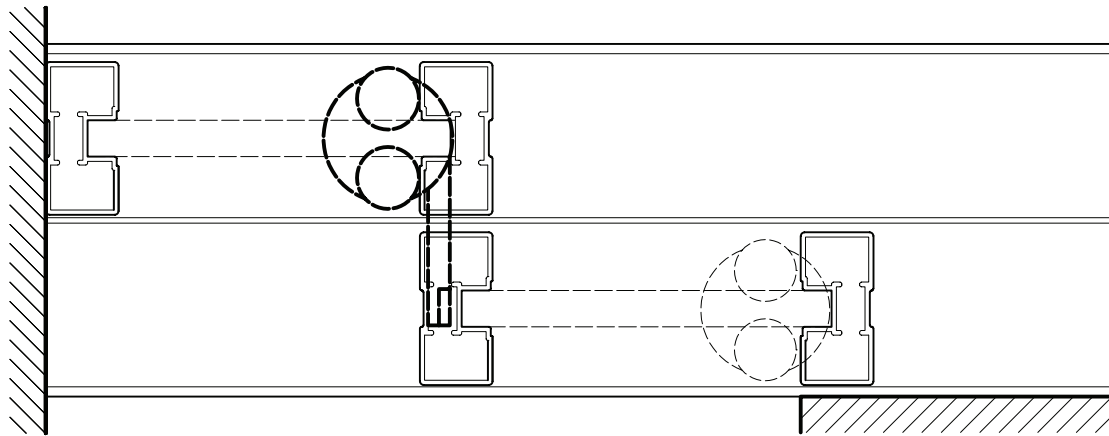

Closed position

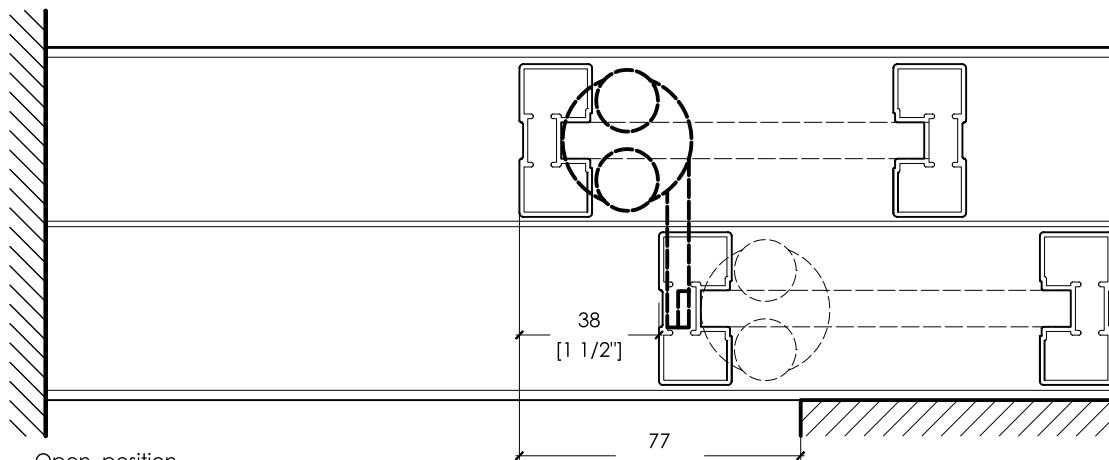

Open position

### 8.3\_ S1500 Ganging notes

The ganging device makes it possible to open and close two AIR doors in one motion. Like the ground plate with roller, the ganging device is concealed under the bottom rail and keeps each door in line with the other doors. The first door will always have a ground plate with roller, which serves to anchor both doors to the floor. Refer to the diagrams to specify left or right ganging device.

Please note: doors ganged to each other stack staggered from one another (see diagrams).

# SYSTEM DESCRIPTION\_ AIR

## SLIDING DOOR SYSTEM

8.4\_ S3000 Ganging / double, left

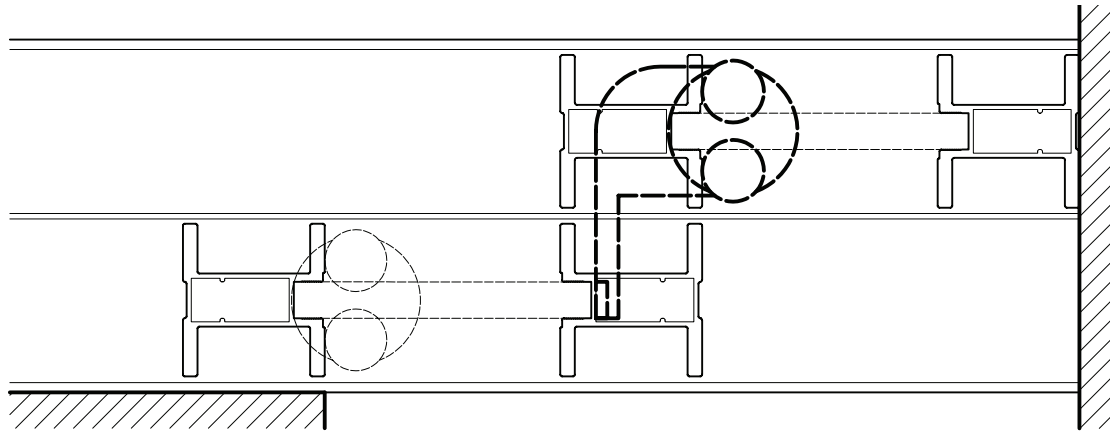

Closed position

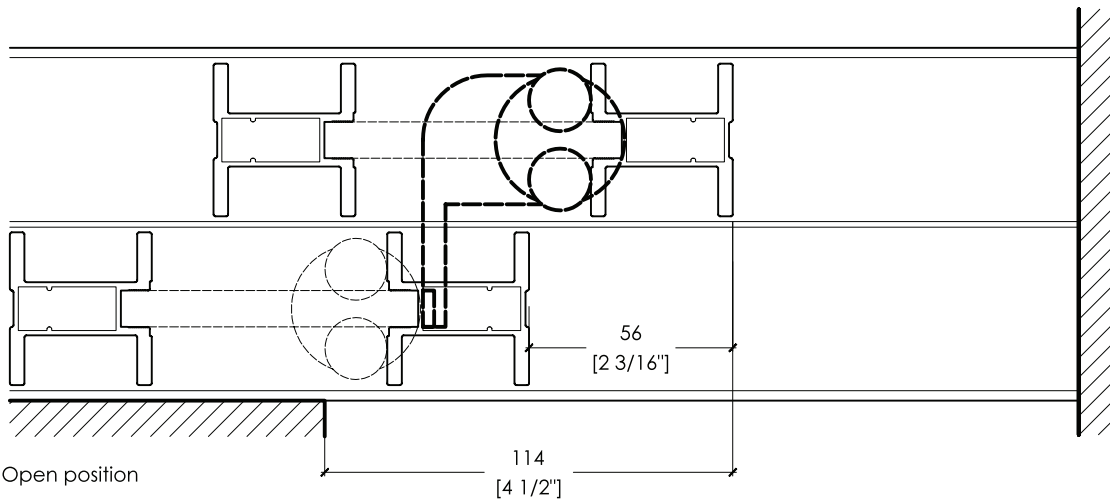

Open position

8.5\_ S3000 Ganging / double, right

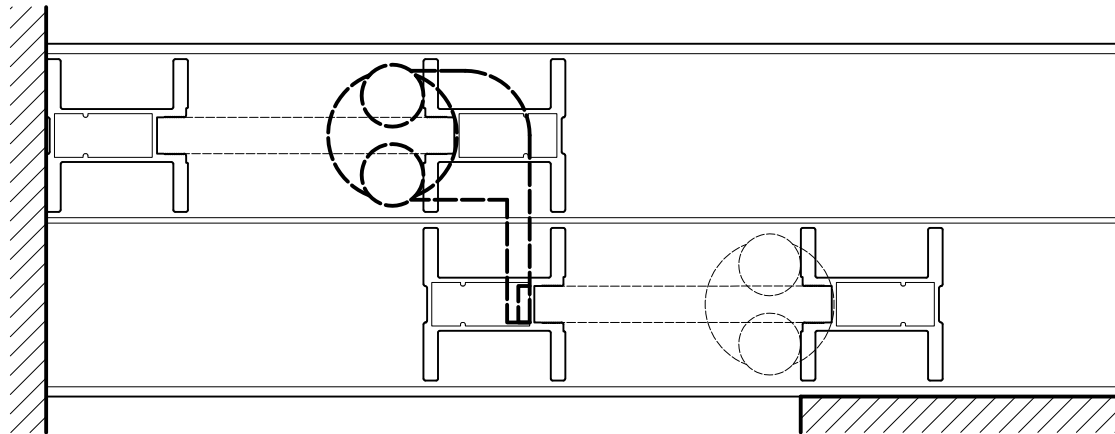

Closed position

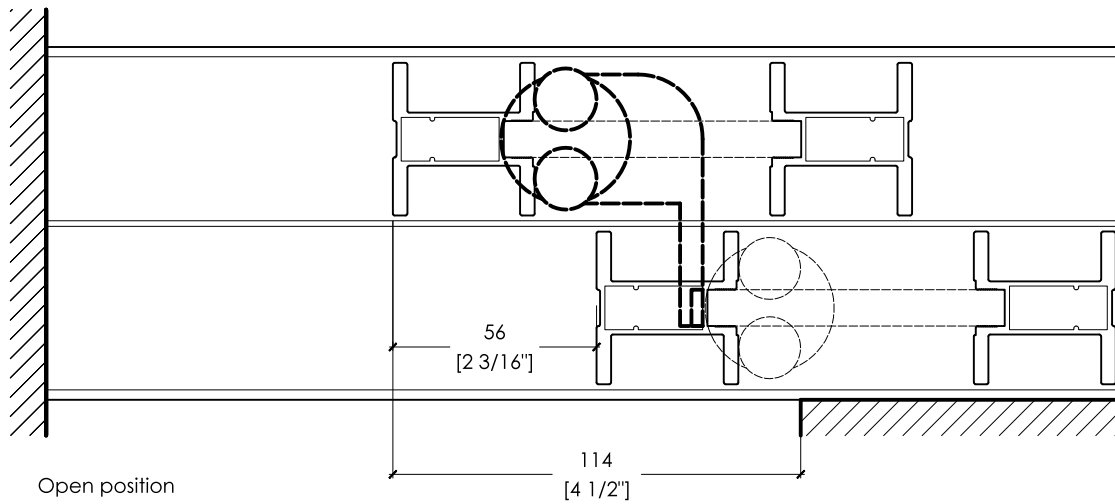

Open position

8.6\_ S3000 Ganging notes

The ganging device makes it possible to open and close two AIR doors in one motion. Like the ground plate with roller, the ganging device is concealed under the bottom rail and keeps each door in line with the other doors. The first door will always have a ground plate with roller, which serves to anchor both doors to the floor. Refer to the diagrams to specify left or right ganging device.

Please note: doors ganged to each other stack staggered from one another (see diagrams).

# SYSTEM DESCRIPTION\_ AIR

## SLIDING DOOR SYSTEM

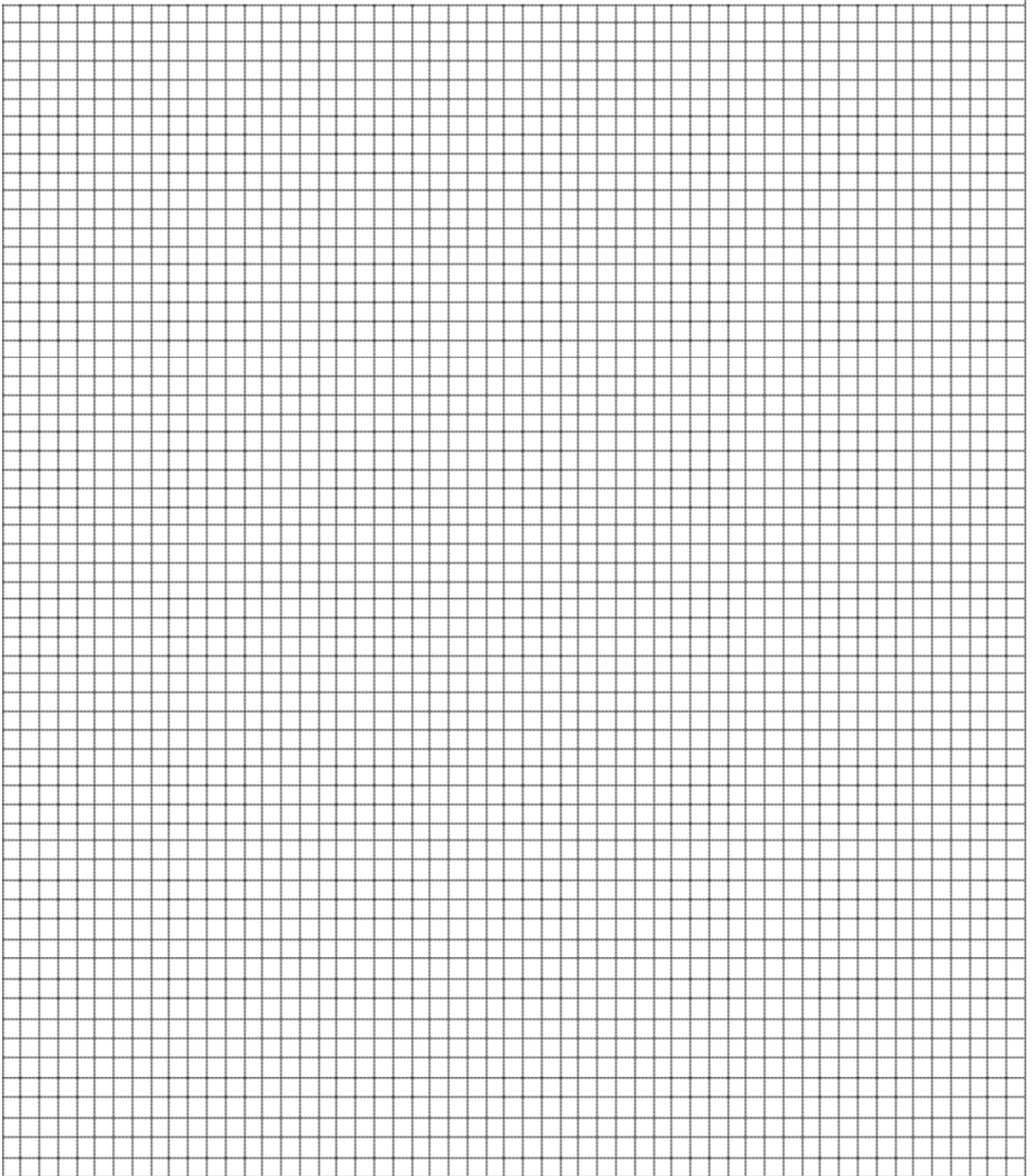



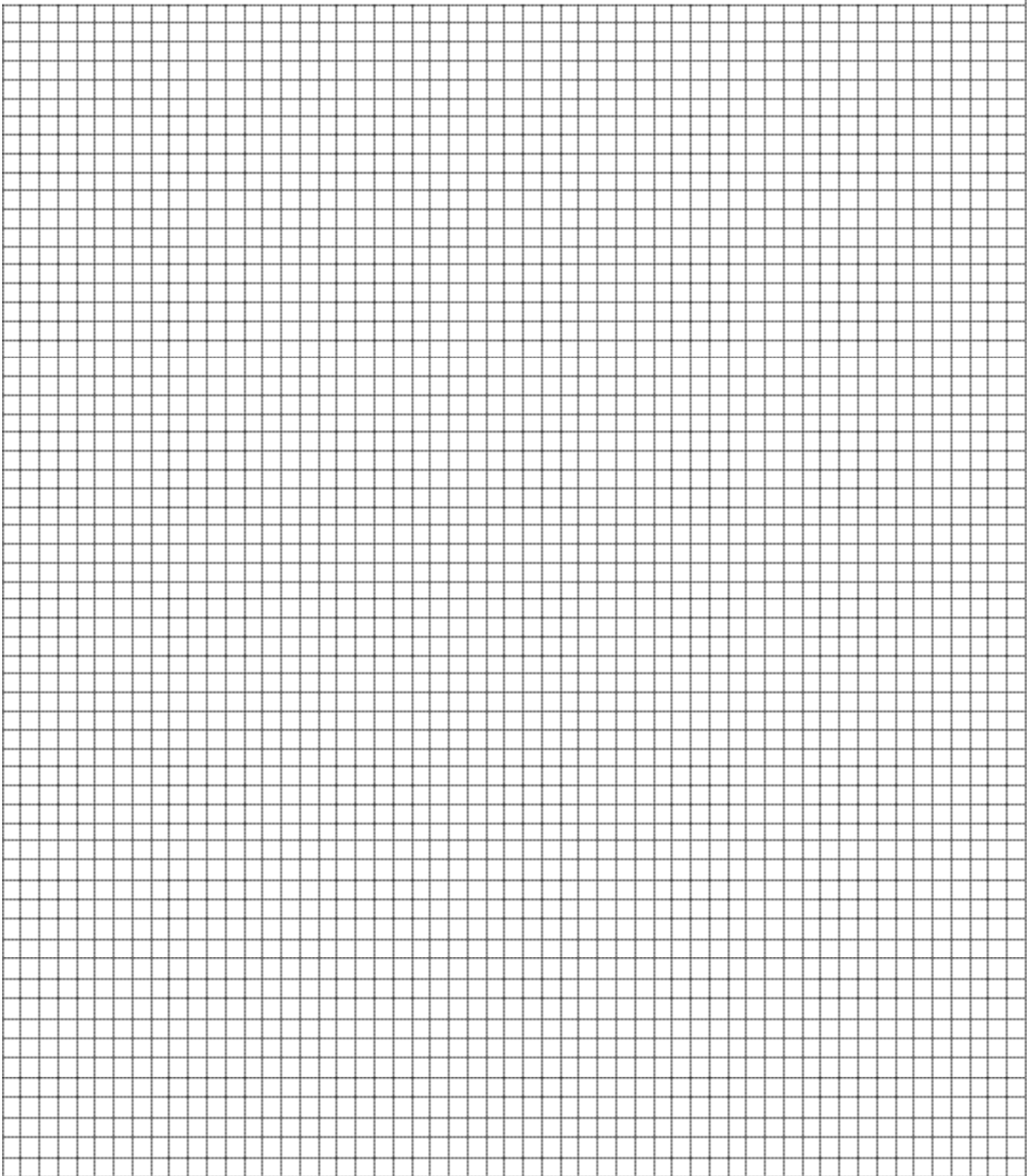

Technical specifications are subject to change. All rights reserved raumplus North America.  
Should you have any further questions, please contact your raumplus representative.

Published by:  
raumplus North America

Canada / USA 866 580 0112